

WHITE RIVER LUMBER COMPANY

ENUMCLAW, WASHINGTON, Aug 15th 1923

Mr Geo D. Long
Tacoma Wash.

My Dear Mr Long.

We made up a statement
how the increase in Pierce County
Valuation will effect us. Our valuation
will be increased 86% and with a
prospect of a new cruise for next year.

Yours very truly
A. G. Hanson



Pierce County Wash.

Stumpage Val'n
Per 1000 FT

	Description	Ac	Val'n 1922	Val'n Proposed	Increase	% Increase	County Cruise	Stumpage Val'n Per 1000 FT	
								Present	Proposed
T19-R7	S ² of SE ⁺	Sec 12 80	153000	282000	129000	84+	3799m	# .40+	# .74+
T19-R8	Lots 3+4	Sec 2 123	159500	250500	91000	57+	2873m	.55+	.87+
"	SW ⁺ NE ⁺ +W ² SE ⁺ -Lot2-	Sec 4 120	569000	897000	328000	57+	12667m	.45-	.71-
"	NE ⁺	Sec 14 160	206000	398500	192500	93+	6502m	.31+	.61+
"	E ² of NE ⁺	Sec 22 80	133000	177000	44000	33+	3147m	.42+	.56+
"	N ² NW ⁺	Sec 22 80	93500	149500	56000	60-	2306m	.40+	.65-
"	NE ⁺ SW ⁺ =S ² SE ⁺ =NW ⁺ SE ⁺	Sec 24 160	51000	128500	77500	152-	2622m	.19+	.49+
"	SW ⁺ NW ⁺ =W ² SW ⁺ SE ⁺ SW ⁺	Sec 24 160	67000	159000	92000	137+	3151m	.21+	.50+
"	E ² NE ⁺	Sec 26 80	24000	60000	36000	150	980m	.24+	.61+
"	S ² SE ⁺ =SE ⁺ NE ⁺ =NE ⁺ SE ⁺	Sec 28 160	241000	409500	168500	70-	6308m	.38+	.65-
"	SE ⁺	Sec 30 160	320000	687000	367000	115-	10964m	.30-	.63-
T19-R9-	SE ⁺	Sec 8 160	221000	428000	207000	93+	5713m	.38+	.75-
"	Lots 8+9	Sec 14	42500	156500	114000	266-	1502m	.30-	1.04-
"	" 3+4	Sec 14	139000	275000	136000	98-	5028m	.27+	.55-
"	E ² NW ⁺ =E ² SW ⁺	Sec 20 160	65000	108500	43500	67-	2146m	.30+	.50+
"	NE ⁺	Sec 24	133000	301000	168000	126+	4212m	.31+	.71+
TOTAL			2617500	4867500	2250000	86%	73920m	Avg .35+	.66-



WHITE RIVER LUMBER COMPANY

ENUMCLAW, WASHINGTON, Oct 12-1925

Mr Geo S Long Gen Mgr Weyerhaeuser Timber Co
Tacoma Wash

Dear Mr Long: I enclose a letter received from our man at Omaha. Our competitors have been advertising our hemlock for us free of charge to us. Sometime a knock is a boost for Mr Lawrence Dods enclosed orders for three cars at good prices.

Mr Olson and I leave here Sunday Oct 18th on the North Coast limited.

Yours very truly
A. S. Hanson



LAWRENCE DODDS COMPANY

WHOLESALE AND COMMISSION

LUMBER - POSTS - SHINGLES

618-20 KEELINE BUILDING

PHONE ATLANTIC 5200

OMAHA

October 7, 1925.

White River Lumber Co.,
Enumclaw, Wash.

Dear Gossard:

I have acknowledgment of our letter of October 1st with reference to the shingle situation. We very seldom have a call for extra stars. It means quite a little to us however, at times, to be able to put in perfect brand clears and sometimes helps us to get an order, especially from the smaller yards. However, the dealers can and most of them do order their shingles in straight cars at slightly lower prices than mixed with lumber.

I have noted your comments with reference to prices. Our price on uppers is satisfactory. Some of the mills as you of course know, are considerably under us, particularly on inch common and dimension, but I can pick up some business for you and it will be my pleasure to do so.

I am putting out a circular today at \$2.00 off on 20' and shorter and \$2.50 off on inch common. If you have a surplus of 1" and want to move it I expect this price really should be \$3.00 off, however, this will make very little difference on the average order for the small country dealer. We now have a number of customers in the territory that are willing to give us preference on White River stock.

I have also noted that some of our competitors who have been very solicitous of getting the White River account in this territory have had quite a little to say to the dealers not at all complimentary to our lumber. A number of the dealers have told me that some of our competitors have advised them against using White River stock and that it was all hemlock. It is perfectly satisfactory to me to have them do this. If we can have our competitors advertise us it will save me a lot of expense in keeping our stock before the trade.

With very kind regards, I am,

Yours very truly,

LAWRENCE DODDS COMPANY

LD:ET

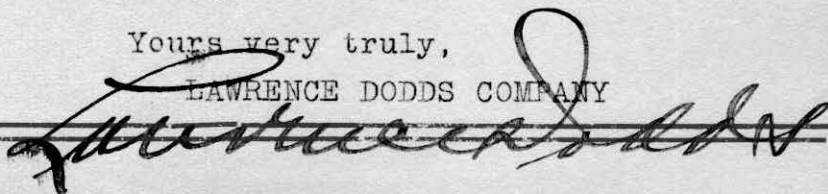

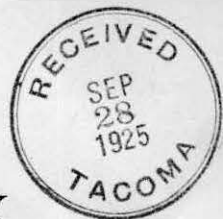

WHITE RIVER LUMBER COMPANY

ENUMCLAW, WASHINGTON, Sept 26. 1925

Mr Geo S Long

~~WARRS~~ ~~SA~~ ~~LONG~~

Gen Manager Weyerhaeuser Timber Co
Tacoma Wash.

Dear Mr Long.

I enclose a sketch

of Section 2-19-7 and the forty we like to have is NE⁴ of SE⁴. The extension we will have to make on our railroad will be the main line up White River. To get to this timber we will have to bridge Scatter Creek which will take some time.

I enclose a map showing the timber we bought from the N.P. This map is for your files.

Yours very truly
A. G. Hanson

WHITE RIVER LUMBER COMPANY

ENUMCLAW, WASHINGTON,

Sec 2-19-7.

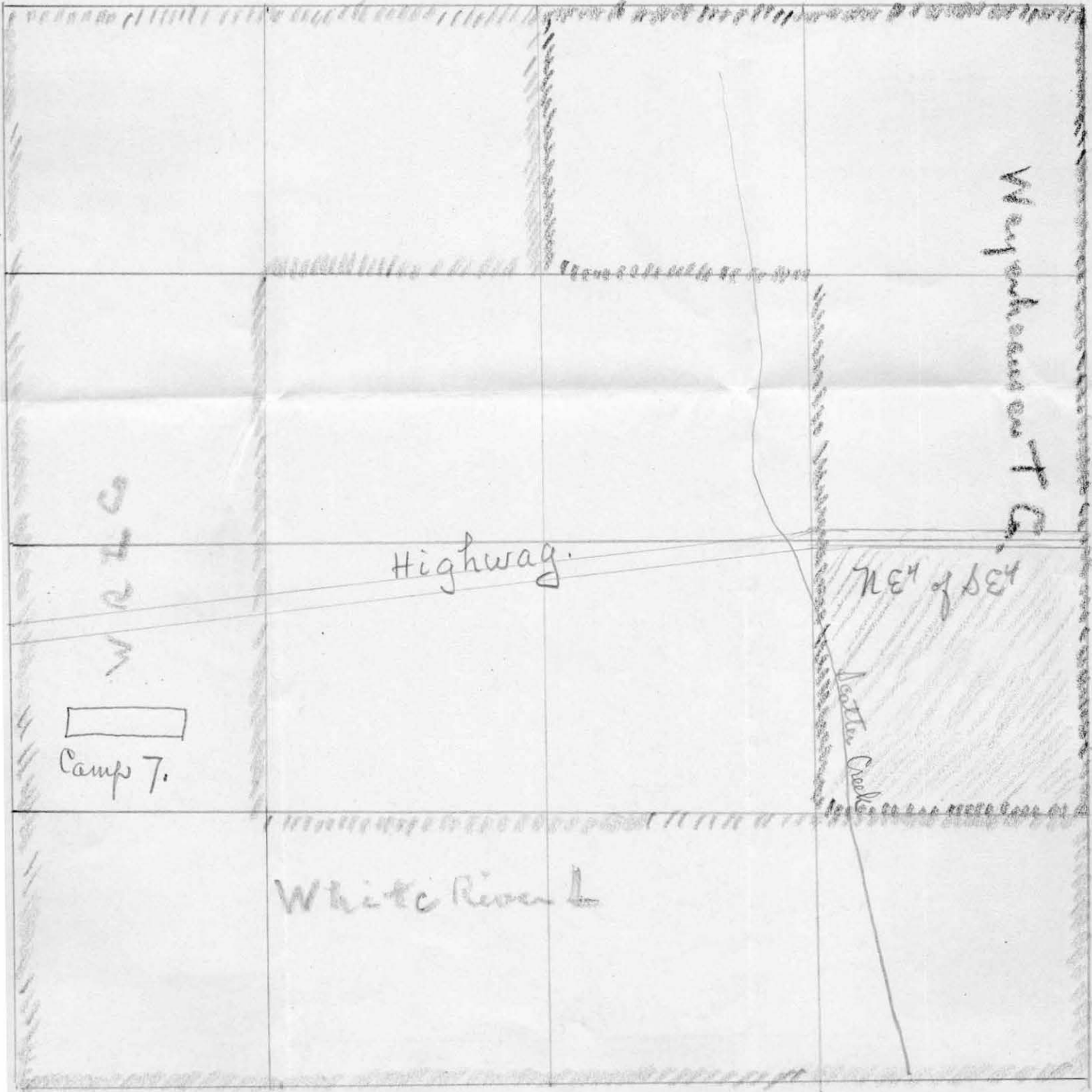

Loans

WHITE RIVER LUMBER COMPANY

ENUMCLAW, WASHINGTON.

September 24, 1925



Mr. George S. Long,
General Manager
Weyerhaeuser Timber Co.
Tacoma, Washington

Dear Mr. Long:

I was up to see the eighty acres in Section 2-19-7 and I found the highway was dividing these two fortys practically on the half section line. Our railroad ends within a thousand feet of the NE $\frac{1}{4}$ of SE $\frac{1}{4}$ Section 2-19-7 and the forty together with the one we already own would keep us in Cedar for Shingles until our arrangements have been completed.

The mill is running pretty good but needs a few adjustments before we will get a full output. We cut 180 M ft. lumber scale the second day.

Yours very truly,

A. S. Hanson

AGH SS

WHITE RIVER LUMBER COMPANY

ENUMCLAW, WASHINGTON, Sept 19-1925

Mr Geo S Long
Gen Manager Weyerhaeuser Lumber Co
Tacoma Wash.

Dear Mr Long:

I enclose check for 34,234¹⁶ representing payment in full on contract 654. The note is \$33,330⁰⁰ and we figure the interest to be \$904¹⁶. Hoping this is satisfactory I beg to remain

Yours very truly
A. G. Hanson.



33,330.00

Discharged
9-22-25
\$34,234.16

9-27-25
47-25
5-15-

166.65
88.33
88.33
916.67
904.16
12.51

mmmmmm
165

WHITE RIVER LUMBER COMPANY

ENUMCLAW, WASHINGTON, Sept 11-1925

Mr Geo A Long
Tacoma Wash.

Dear Mr Long:

Any day you find time to drive up is agreeable to us. My wife is anxious to show the young ladies her garden before any frost will spoil the flowers.

We are about done with the new manufacturing room and the mill will be closed down next week in order to connect the two mills.

Mr Olson and I will be down any day you have time to see us. I am staying around the mill all the time and I have not been in Tacoma for a long time.

Yours very truly
A. G. Hanson

August 25, 1925.

White River Lumber Company,
Enumclaw, Washington.

Mr. Hansen.

Gentlemen:

Again I am called upon to thank you and compliment you, first, for sending to me the report of the business transacted in July, and to compliment you on the results, even though they are not as satisfactory to you as you would like to have them.

We always realize that monthly statements may not always reflect actual performance, for in every lumber company's affairs they frequently, during some one month, begin to have unusual conditions of expense, and in the same month may have opportunity to sell lumber above the average, and whenever the latter is done, they have to at some time later on sell lumber below the average. Therefore, while these monthly statements are illuminating and useful, it is the final annual statement that counts the most, and I am sure you are going to have a very creditable one for 1925.

Yours very truly,

WEYERHAEUSER TIMBER COMPANY

GSL-FH

WHITE RIVER LUMBER COMPANY

ENUMCLAW, WASHINGTON, Aug 22-1925

Mr Geo S Long
Tacoma Wash.

Dear Mr Long: I enclose our report for the month of July which is not as good as I like to see it. Our average price is low on account of selling the no 2 and 3 common we had on hand for some time. We are doing the same this month and I think by the end of this month we will be pretty well cleaned up on all lower grades.

Yours very truly
A. J. Hanson



WHITE RIVER LUMBER COMPANY



ENUMCLAW, WASHINGTON, July 20-1925

Mr Geo S Long
Genl. Manager Weyerhaeuser Timber Co
Tacoma Wash

Dear Mr Long: I enclose statement for the month of June. It is not as good as previous months on account of the large amount of hemlock in our timber at this time. The woods are getting very dry. We had a very dependable fire warden but he was called in to Seattle and discharged. We have not seen or heard of any warden since.

Yours very truly
A. S. Hanson

Weyerhaeuser Timber Company
Tacoma, Washington

June 22 1925

White River Lumber Co

Emmuelaw, Wash

GENTLEMEN:-

Your note for \$ 33,330.⁰⁰ dated April 7 1925, and bearing interest at the rate of

6 % per annum, will be due and payable at our office in Tacoma, Wash., on July 7 1925

The following payments have been endorsed on this note:

none

33,330

499.95

\$ 33,829.95

33,330.00
499.95
33,829.95

33330
16665
499.95

Kindly give the matter your attention, obliging,

Yours truly,

WEYERHAEUSER TIMBER COMPANY

By: *[Signature]*



May 15th, 1923

White River Lumber Company

Enumclaw, Washington.

Mr. Hansen

Dear Sir:

Thanks for your favor of the 10th enclosing map showing your lands colored in green in Townships 20 North Range 7 and 8 East and Townships 19 North, Ranges 7, 8 and 9 East.

The only intelligent way to talk exchange, of course, is to get very familiar with the country by an actual survey, which has in mind the possibilities of railway development, but from our records here, what we own north of the river in Townships 20 North Range 7 East and 20 North of Range 8 East, constitutes the very cream of our holdings up the White River, and by this we are referring specially to Sections 25 and 35 in Township 20 North of Range 7 East and to Sections 29, 31, 33, 34 and 35 in Township 20 North of Range 8 East. We certainly do not want to part with this nor any part of it, and while I appreciate your anxiety to get into Sections 25 and 35 in 20 - 7 East, it would open up that proposition in a way that would spoil it for our holdings beyond. Our intention is to log in that country, and as we own timber on four sides of Section 36 - 20 - 7 East, we naturally would expect to acquire this section also, when it was put up for sale by the State, and you can see at once what a fine block of timber that would give us to open up a logging camp. I do not think that we want to spoil this chance.

Mr. Hansen - 2 -

The timber which each of us have in the south part of 19 - 8 East and 19 - 9 East is a long ways off for development and much of it I am inclined to think carrying a load of hemlock and a low grade of fir which does not make it very desirable for an exchange. We probably have even more of that kind of timber than you, but it is the last timber to be logged in that country and I cannot imagine there is any particular reason why we should be anxious at the present time to exchange it.

However, I will give this matter further thought and try to get around to some suggestion before long, but manifestly we would not want to trade the timber which we have north of the river for any timber which you have south of the river.

Yours very truly,

WEYERHAEUSER TIMBER COMPANY.

WHITE RIVER LUMBER COMPANY

ENUMCLAW, WASHINGTON.

May 10, 1923

Mr. Geo. S. Long
Manager Weyerhaeuser Timber Co.
Tacoma, Washington

Dear Sir:

We have filled in our holdings in green ink on the map you sent us. You will notice that we own practically the same amount of Timber on the south side of White River as you own on the north side when sections 1, 11, 13 and 14 are deducted, which is in the belt of young timber now too small to cut. The land remaining in white is practically all State lands and nearly all private land is eliminated.

If it is agreeable to you we would like to exchange our holdings with you so as to get a solid block. We need badly section 35 and 25 T 20-7 and would like to make some arrangements with you so we will be able to continue logging where we now are until you have time to make your full investigation of the proposed exchange.

Yours truly,

WHITE RIVER LUMBER COMPANY

BY *A. S. Hanson*

AGH:JD



White River Lumber Co^s
Logging Road Sec 2 T. 19. R. 7E

Sec 2-19-7

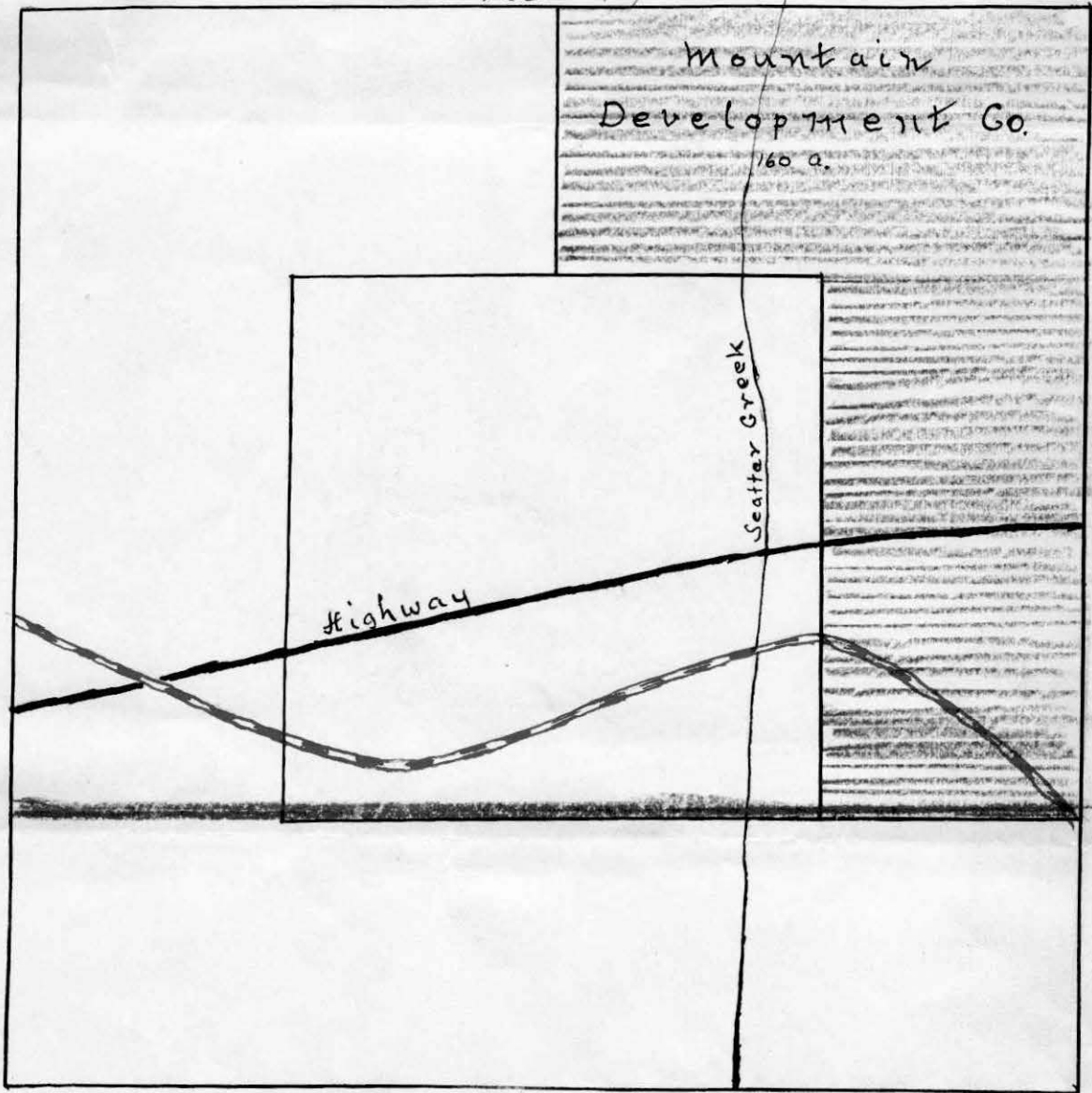

N^{1/2} of NE^{1/4}
SE^{1/4} of NE^{1/4}
NE^{1/4} of SE^{1/4}

S 100ft of N^{1/2} of S^{1/2}



White River Lumber Co
Logging Road in Sec. 7. T. 19. R. 8 E.

Sec. 7-19-8

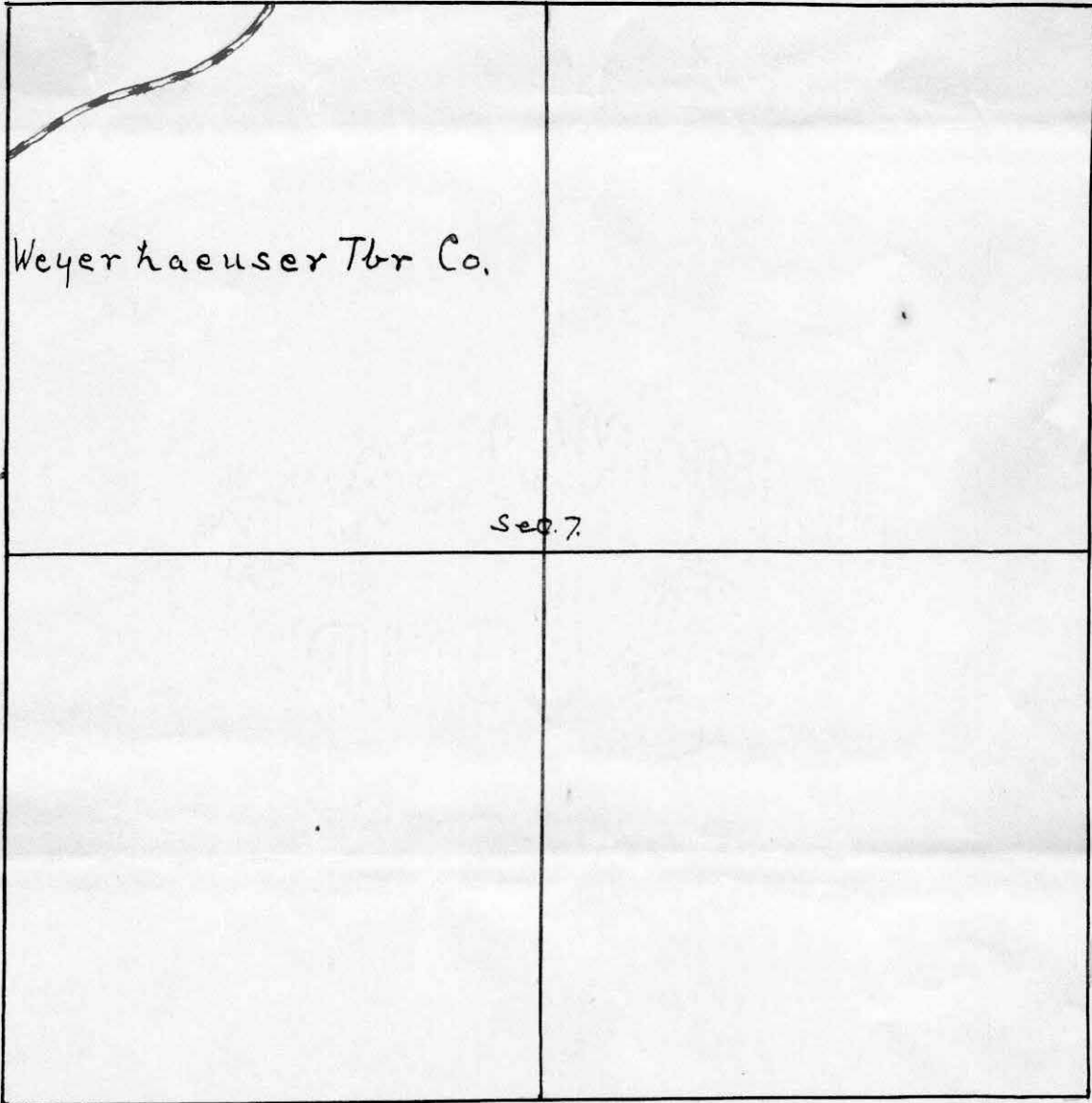

RECEIVED
MAY 17 1923

White River Lumber Co.
Logging Road in Sec I T.19R7E.

Sec. I - 19 - 7.

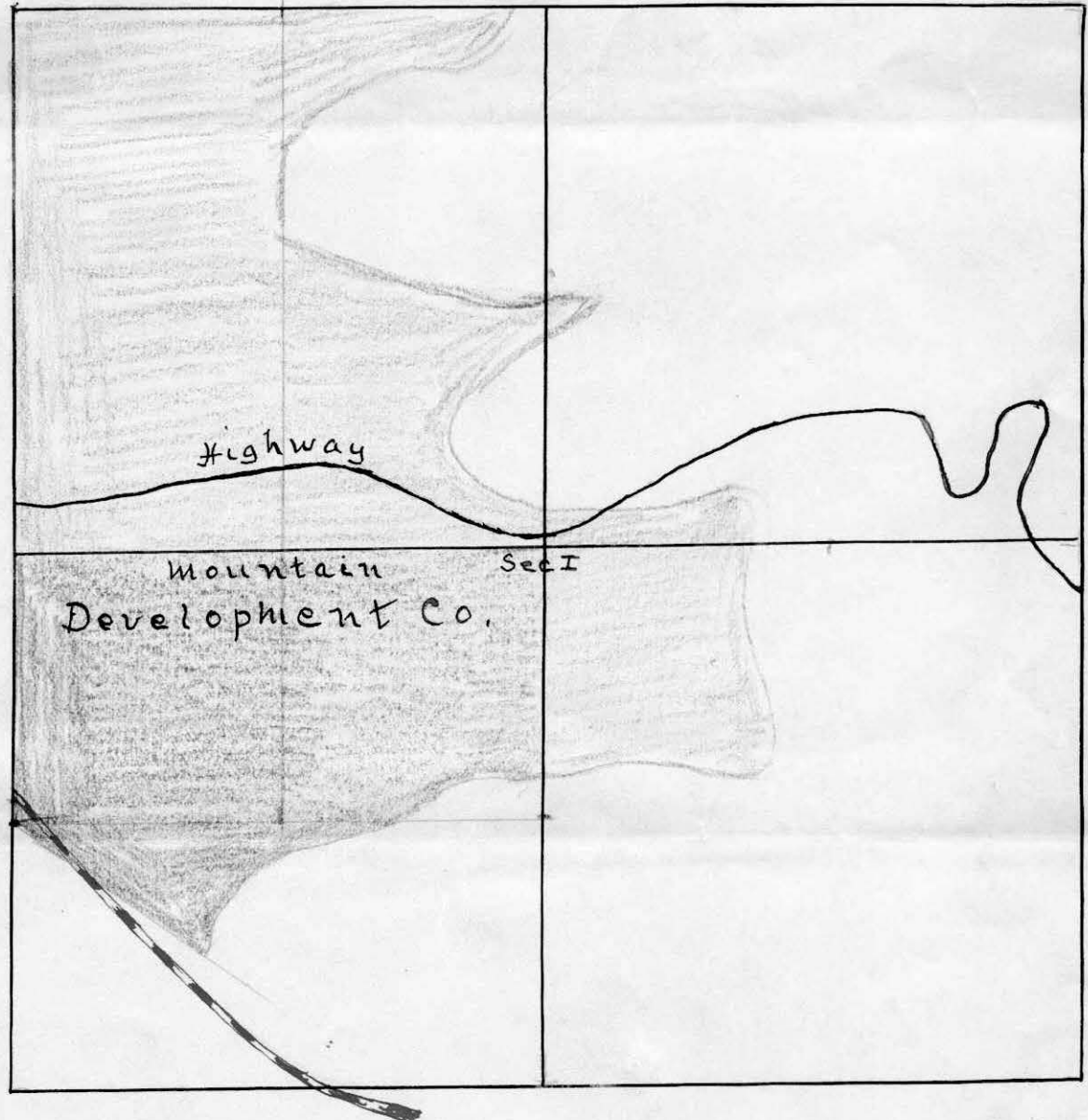

RECEIVED
MAY 17 1923

May 15th, 1923

Mr. Minot Davis:

Attached please find plat of lands up White River the red lands being that which we own and the green the Milwaukee Land Company lands which have been purchased by our friend Mr. Hansen of the White River Lumber Company.

He is very anxious for us to trade with them and naturally wants to get north of the river and for us to take his timber south of the river. The map shows that in Section 35 - 20 7 East and Section 1 - 19 - 7 East there are some irregular lines, which represents property owned by Mountain Development Company, and we own the Mountain Development Company, so that that timber is available for our own use.

You will see from what I say how I have approached this subject with Mr. Hansen. I think that if we do exchange with him we can make a pretty good trade, but I dont think we want to be in a hurry about the exchange, but if there is any way for us to assemble topographical sketches of these townships, so as to give us some idea of the possible railway development, I would be glad to have this done.

Yours very truly,

Long
A main line must follow fairly near White River. Both the North & the South sides of same are practicable; and the river can be crossed without undue expense in 19-8 & 19-9 E.

M.D.

WHITE RIVER LUMBER COMPANY

ENUMCLAW, WASHINGTON.

April 27, 1925

Mr. George S. Long
Tacoma, Washington

Dear Sir:

We will be very much pleased to go in with you on a cruise of the timber up White River and we want to pay our share of the expense. We also expect to pay the cost in connection with the work Mr. Onstad is doing for us.

Orders are coming in in excess of production and at prices very satisfactory. Our average price so far this month is \$23.40. To this we will have to add the underweights which will average around \$2.00, making our total over \$25.00.

We shipped up to the 25th of this month hundred eleven cars and will reach a hundred fifty cars for the whole month of April.

Some of these days I hope to see you up here to help in figuring out the problem of saving the small trees.

Sincerely yours,

A. H. Hanson



AGH SS

March 31, 1925.

White River Lumber Company,
Enumclaw, Washington.

Mr. Hansen.

Dear Mr. Hansen:

With reference to your suggestion of March 30th as it pertains to timber in the N $\frac{1}{2}$ of Section 25, we are going to depart from our usual practice in negotiations by sending you enclosed herewith our full cruise on all of Section 25, recently made by Mr. Fenton, and on the N $\frac{1}{2}$ of which he puts 31,173,000 ft., his cruise on the whole section being 62,599,000 ft. We had an old cruiser by the name of Cole on this section sixteen years ago, who found quite a little more fir and less hemlock than Fenton reports. Together with Mr. Fenton's report we are handing you another cruise, being a check cruise made by our Mr. Brigham on the NE $\frac{1}{4}$ of Section 25, the total on this quarter section being 16,325,000 ft. as against Mr. Fenton's cruise on the same section of 16,032,000 ft.

Mr. Fenton reports more old growth than Mr. Brigham does, but in Mr. Brigham's comments he says that while there are a few very distinctive old growth trees, the predominating type is an intermediate grade that is smooth and a little difficult to class whether it is what cruisers call "Old Growth" or "Young Growth".

Then again we would like to invite your attention to the SW $\frac{1}{4}$ and the W $\frac{1}{2}$ of SE $\frac{1}{4}$ of Section 13 in this township, which before you move out we would like to have cleaned up if it is practical for you to do so. Our Mr. Davis has gone over all of

Mr. Hansen -2-

this matter very thoroughly, and at my request has made prices on it such as are suggested on the cruise reports themselves, and what I want to put up to you is whether there is anything the matter with the cruise for quantity or anything the matter with the price that is suggested, and if you think there is to tell me so frankly, returning to us for our files the cruises which are submitted.

Yours very truly,

WEYERHAEUSER TIMBER COMPANY

GSL-FH

WHITE RIVER LUMBER COMPANY

ENUMCLAW, WASHINGTON, Mch 30-1925.

Mr Geo S Long, Genl. Manager
Weyerhaeuser Timber Co
Tacoma, Wash.

Dear Mr Long: This week will finish our logging on Sec 24-20-7 and before we take up the track we should finish logging the north of Sec 25. We have six miles of track to take up. If you would sell us north half of Section 25 now we can keep right along and finish that part while the camp and equipment is up there. It will also give us plenty of time to negotiate our big deal.

Yours very truly
A. G. Hanson.



WHITE RIVER LUMBER COMPANY

ENUMCLAW, WASHINGTON, Mch 13-1925-

Mr Geo S Long Mgr
Weyerhaeuser Tim. Co
Tacoma Wash.

Dear Mr Long:

We just received the analysis of costs and sales for the year 1924 and if you have no copy you will probably be interested to see ours. To me it is a guiding star and I read it very carefully. On the last page December report we fell down to the twentieth place on account of the cold weather. The ice in the pond and on the flume made operation very difficult so we closed down for two weeks and it shows quickly in the cost —

Mr B.R. Lewis wrote me what a good price the biggest and the best mills get and it shows here that the St Paul & Tacoma (the largest mill) got 32 cents less than we did and that Bloedel Donawaw (next largest) 25 cents less than our price. Figuring profits St Paul made 16⁴ or \$143,974⁴⁰ and Bloedel 12 cents or \$24,590⁴⁰. I think Bloedel next to Long Bell pays the biggest interest.

I will be looking for you next week. I am very anxious for you to come up and look at small timber.

Sincerely,
A.S. Hanson

WHITE RIVER LUMBER COMPANY

ENUMCLAW, WASHINGTON, Feby 4-1925

Mr Geo S Long
Tacoma Wash

Dear Mr Long:

Mr Olson and I will
be down Saturday morning.

The figures given you
are the General Appraisal Co's depreciated
totals. The appraisement was taken last
August. Anyhow I will tell you all
about it next Saturday.

Sincerely yours
A. S. Hanson

Davis

WHITE RIVER LUMBER COMPANY

ENUMCLAW, WASHINGTON.

January 3, 1925



Mr. George S. Long, General Manager
Weyerhaeuser Timber Company
Tacoma, Washington

Dear Mr. Long:

Mr. Olson and I were up the McClellan Pass Highway New Years Day to see what had happened. We found the big blow on the line between Section 5 and 6-19-8 and not on Section 1, as I first reported to you.

Section 6 was hurt the most. Outside of that point very little timber had blown down. The worse blow is on Section 13-20-7. This section is too high to log until Spring. Our switchback is up to it and this timber should be logged as soon as possible in the Spring.

We are on our last setting on Section 24-20-7 and the timber on the north side of Section 25 should go out while the tracks are there. The timber on Section 24 is all felled and bucked.

This last wind blew down some trees from Section 25 on our logs. We scaled these windfalls and found 7,692 ft. Fir, 4,112 ft. Hemlock and 10,179 ft. Spruce. We cannot see any way of getting our logs out but to take the windfalls at the same time.

I can come down to Tacoma any day you have time to see me. Perhaps we can make better progress on our deal after the yearly reports are finished.

Yours very truly

WHITE RIVER LUMBER COMPANY

A. G. Hanson

AGH SS

Hanson

December 30th, 1924.

White River Lumber Company,
Enumclaw, Washington.

Mr. A. G. Hanson

Dear Sir:

Your letter of December 29th is before me and I am sorry to hear that the storm has blown down a good many of our big trees up on the McClellan Pass Highway and I am a little afraid if it created this havoc in this spot, there are other places in the woods equally bad.

As to the North half of Section 25 in Township 20 North of Range 7 West, how long would it be before you would want to commence operations in this particular spot - is it likely to occur before we can make any further progress in our proposed plan?

Wishing you the full compliments of the season, I beg to remain,

Yours very truly,

WEYERHAEUSER TIMBER COMPANY.

WHITE RIVER LUMBER COMPANY

ENUMCLAW, WASHINGTON.

December 29, 1924

Davis



Mr. George S. Long, Manager
Weyerhaeuser Timber Company
Tacoma, Washington

Dear Mr. Long:

We have had a couple weeks of very bad weather with high winds. It blew here for three straight days. On Section 1-19-7 and Section 6-19-8 a large amount of the big trees are down and it took the highway department a week to open the road. This is the large timber on the hill just east of Scatter Creek.

The wind was very severe on top of the hill where our Camp #9 is situated and a lot of timber blew down there.

When you were here we talked about you selling us the north half of Section 25-20-7. We should take this timber out while our track is still there and as it will take some time to finally get together we would like to clean up on the many switchbacks we have on this hill.

Yours very truly

WHITE RIVER LUMBER COMPANY

A. G. Hanson

WHITE RIVER LUMBER COMPANY

ENUMCLAW, WASHINGTON.

December 21, 1927

Mr. Geo. S. Long, Gen. Manager
Weyerhaeuser Timber Company
Tacoma, Washington



Dear Mr. Long:

This new provision in the revenue bill is certainly a blow to the timber owners. I had no idea that such changes were contemplated.

I telegraphed our Senators and I hope they will help us so the provision in the bill will be changed. Politics are disgusting but it is necessary to do some of it for self protection.

Yours very truly,

A. G. Hanson

AHG:L

Tacoma, Wash., November 4, 1927.

White River Lumber Company,
Enumclaw, Washington.

Dr. To **Weyerhaeuser Timber Company**

Terms: Net cash:

75 Double Rolls of 216 sq. ft.
Mule Hide Roofing with nails and
cement -

150 squares at \$2.60

\$390.00

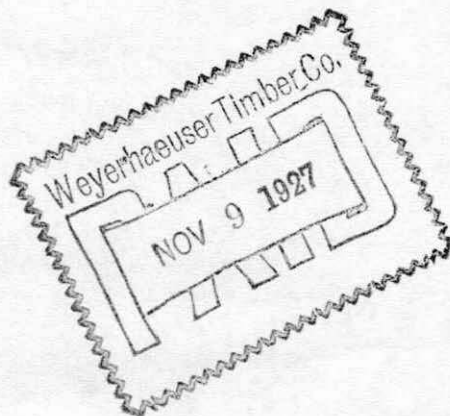

1/2

WHITE RIVER LUMBER COMPANY

ENUMCLAW, WASHINGTON, Sept 27th 1927

Mr Geo S Long, Gen. Manager
Weyerhaeuser Timber Co
Tacoma Wash.

Dear Mr Long:

I enclose copies of
Correspondence regarding purchase of five
Sections in Township 19 N-11 E.

Mr Olson is figuring on
going over this land with our Woods foreman.

I am going back to Minneapolis
and Kansas City to talk things over with
our Salesmen. Seems like writing does not
hit the point. Be back in a week or ten days.

Yours very truly
Al Hanson



WHITE RIVER LUMBER COMPANY

ENUMCLAW, WASHINGTON. Aug 5th 1927

Mr Geo S Long Gen. Manager
Weyerhaeuser Lumber Co
Tacoma Wash



Dear Mr Long:

The two books Forest
Resources of the World arrived here by
parcel post and I want to thank you
for sending them.

Yours truly
A. S. Hanson

WHITE RIVER LUMBER COMPANY

ENUMCLAW, WASHINGTON. July 31st 1927.

Mr Geo O Long
Tacoma Wash



Dear Mr Long: Yesterday we had the Governor and the state highway engineers with us. Also the King County Commissioners some state Senators and others. We went up the highway to White River Camp and had lunch there. We were promised early action in completing the road across the Mountain.

It was a beautiful day and the scenery made quite an impression on the party. The governor had his wife and daughter with him

Sincerely yours
A. G. Hanson

WHITE RIVER LUMBER COMPANY

ENUMCLAW, WASHINGTON.

Apr 11th 1927



Mr George D. Long, Gen. Mgr
Weyerhaeuser Timber Co

Tacoma Wash.

Dear Mr Long:

Another month has gone by. They are
coming to swiftly for us.

You will find enclosed our
accountants report for month of April 1927 besides
a vestpocket report made by myself and I hope
you will be pleased with them when taking into
consideration business conditions at present.

I am looking for you up here
in the near future.

Sincerely yours

A. J. Hanson

March 4th, 1927.

Mr. A. G. Hanson,
White River Lumber Company,
Enumclaw, Washington.

Dear Sir:

Noting your letter of Feb. 26th having to do with the mineral reservations which exist in the deed our company gave for the $S\frac{1}{2}$ of $SW\frac{1}{4}$ of Section 17 in Township 20 North of Range 6 East quite a few years ago in the same of the same, beg to say, it is quite apparent that Mr. W. D. Lewis, when alive, was unfortunate in making out a deed where he himself did not make the mineral reservations that were in our deed to him.

I hardly know just what I can say of an encouraging nature about this matter, because there is no single officers of our company who has any authority at any time to waive the mineral reservations in our deeds. It can only be done by the action of the Board of Directors at some one of their regular sessions and we have no prospective meeting of our directors until some time in May.

Would suggest that it might be in order for Mr. Smith to write the full details of all these affairs mentioned in your letter and present a request to see what could be done to straighten out this little difficulty that he is in, and I will at least submit it to the Board of Directors when they meet, although I am not at all confident that they would feel inclined to waive their rights

*Mr. Geo. S. Long
2/27*

WHITE RIVER LUMBER COMPANY

ENUMCLAW, WASHINGTON.

February 26, 1927



Mr. Geo. S. Long, General Manager
Weyerhaeuser Timber Company
Tacoma, Washington

Dear Mr. Long:

Mr. Tom Smith, our deputy sheriff, called in the office today telling me that he was in a jack-pot on account of signing a deed to some land bought from your company some twenty years ago. The deed was to P. R. Lewis, D. W. Lewis, and C. T. Smith. The land is the south half of southwest quarter Section 17, Township 20 N Range 6 East. Since then, D. W. Lewis, father of P. R. Lewis and father-in-law of C. T. Smith, died.

Several years ago while D. W. Lewis was alive, they sold this land and in making out the deed overlooked the fact that the minerals were reserved by your company. Now comes another transfer and on examination of the abstract, the flaw is discovered. Mr. Smith asks me to write you and see if anything can be done to fix it with your company.

Yours very truly,

A. G. Hanson



AGH:L

March 4th, 1927.

Mr. A. G. Hanson,
White River Lumber Company,
Enumclaw, Washington,

Dear Sir:

I have noted your letter of the 1st regarding the situation in the N $\frac{1}{2}$ of NE $\frac{1}{4}$ of Section 12 in Township 19 North of Range 7 East where you have acquired from the State of Washington a right-of-way by purchase and where you think it is quite desirable and important for you at the present time to put in your railway grade and have it established before you are disturbed by any possible future activities of the State Highway Commission who may possibly want to re-locate their road.

I think your judgment in this matter must be all right and the only question that runs through our mind is as to whether or not there is any necessity for either you or us at the present time to build this grade through Section 7 in Township 19 North of Range 8 East. Do you feel that it is important to do this in the early future and before the State Highway people get busy?

Yours very truly,

GSL/m

WEYERHAEUSER TIMBER COMPANY

WHITE RIVER LUMBER COMPANY

ENUMCLAW, WASHINGTON.

March 1, 1927

By Davis

Mr. Geo. S. Long, General Manager
Weyerhaeuser Timber Company
Tacoma, Washington

Dear Mr. Long:

The land on the north half of north east quarter of Section 12 is a steep side hill and the railroad up the White River will have to be built on the side of this hill to get support. The country south is low and if we have to go across it would make an adverse grade of over one percent for a long distance. Also heavy construction.

We bought a 200 feet of right of way from the state in the north east quarter of the north east quarter and later the timber on the whole 40 acres. The state is figuring on relocating the highway from the bottom of the hill, half a mile east of our mill pond to Cyclone Creek. The survey has been made and it takes in this right of way we just acquired. There is in the road budget \$200,000.00 for this improvement which bill has not yet passed but looks like it will go through. We are going to put a shovel on this stretch of road and dig out our road bed and it would be a good idea to continue through Section 7 as per enclosed survey.

Any adjustment of the railroad afterwards will have to be made by the highway department. If this looks acceptable to you, please advise us.

Yours very truly,

A. G. Hanson

AGH:L



WHITE RIVER LUMBER COMPANY

ENUMCLAW, WASHINGTON.

TWP 19 N R 7 E

TWP 19 N R 8 E

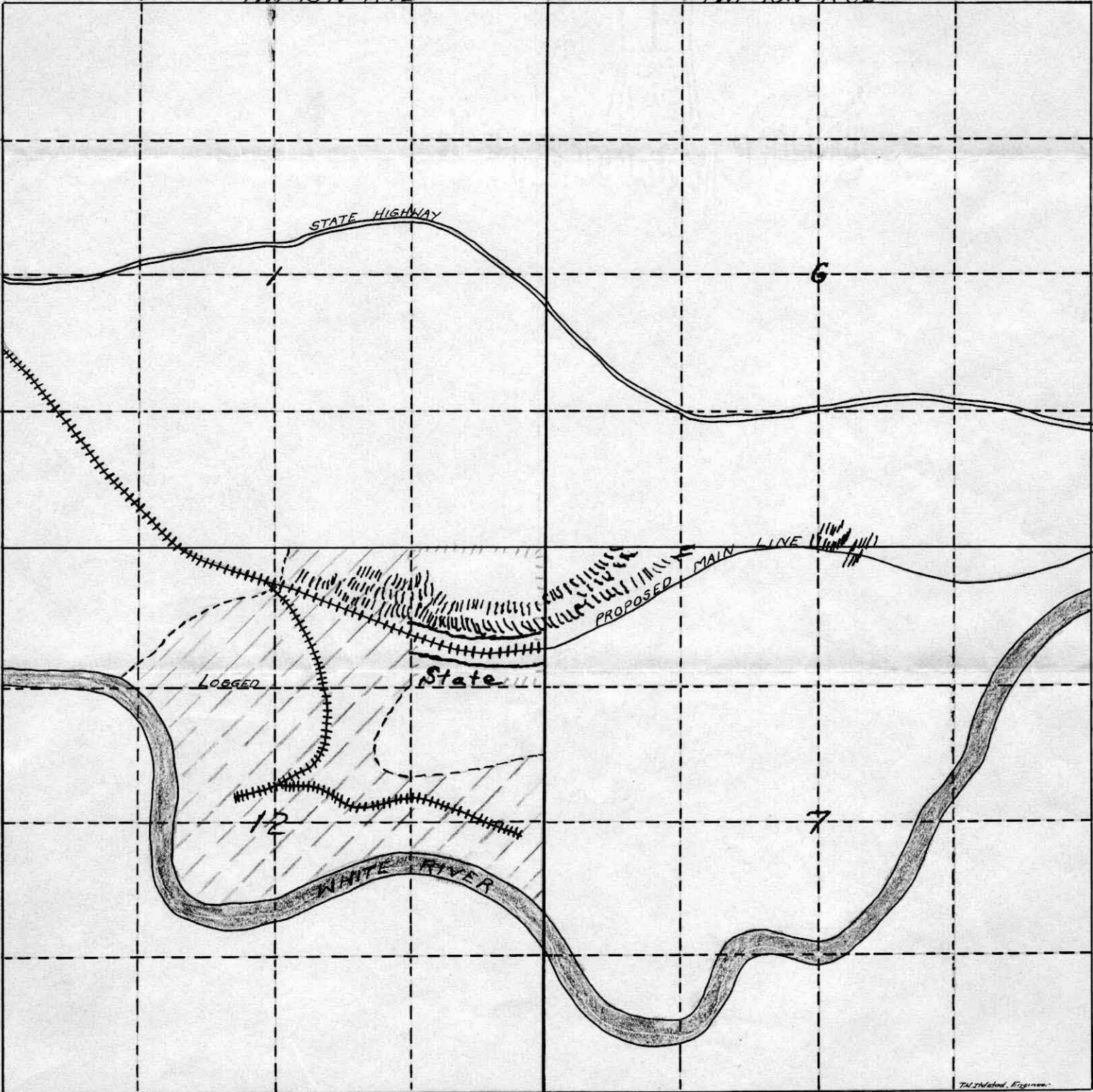

Tacoma, Wash., January 29, 1927.

White River Lumber Company,
Enumclaw, Washington.

Dr. To **Weyerhaeuser Timber Company**

Total of items charged to your account during the year 1926 for salaries and expenses of Draftsmen and Engineers in making plans for reconstruction of front end of saw mill at Ellison, including blue prints, telephone calls, etc.

\$1,221.30

30 yards Detail paper	at 12¢	3.60
17 " Tracing cloth	" 80¢	13.60
Postage and miscellaneous supplies		8.00
Stenographic and clerical work		42.00

42.00

\$1,288.23

No charge made to cover Weyerhaeuser Tbr. Co's expenses for rent, light, telephone, etc.

afw

WHITE RIVER LUMBER COMPANY

ENUMCLAW, WASHINGTON.

January 10, 1927

Weyerhaeuser Timber Company
Tacoma Building
Tacoma, Washington

Gentlemen:

We are enclosing our check on the
Seattle National Bank for \$26125.00 to cover
our note of \$25000.00 due tomorrow, with
interest at 6% amounting to \$1125.00. ✓

Kindly send us canceled note to complete
our records.

Very truly yours,

WHITE RIVER LUMBER COMPANY

A. G. Hanson

AGH:L



*125
1145*

WEYERHAEUSER TIMBER COMPANY
TACOMA, WASHINGTON

December 22, 1930

White River Lumber Company
Enumclaw, Washington

Attention Mr. Pierson

Gentlemen:

Will you kindly forward at your earliest convenience,
after closing your payrolls for the month of December, the re-
port required under Public Liability Policy No. P-2166.

Very truly yours



JSC/r

WHITE RIVER LUMBER COMPANY

ENUMCLAW, WASHINGTON

December 5, 1930

Weyerhaeuser Timber Co.
Tacoma,
Washington

Attention Mr. McCormick



Gentlemen:

We have today executed a Satisfaction of Lien for our Mabton yard which we are returning to the Tacoma office with instructions to present to you that you may affix the seal.

These small items will likely be coming up in the future for our attention and it would be a great deal more convenient if we also had a seal in this office. Would it be possible to have another seal made for us? This lien should have gone direct to Mabton today but on account of no seal we were unable to send it.

Yours very truly,

WHITE RIVER LUMBER COMPANY

By

W. Purson
Accountant

*Mr. Peutz -
Please order another
seal for them have it
delivered to them & bill
sent to them -*

OWP:AH

*Ordered 12/6/30
Reg # 3184*



Whew

WHITE RIVER LUMBER COMPANY

ENUMCLAW, WASHINGTON



November 5, 1930

Mr. F. R. Titcomb
Weyerhaeuser Timber Co.
Tacoma, Washington

Dear Sir:

Before I received your letter I had a talk to Mr. Robbins to move to the Tacoma Building and he was to see about it yesterday. By this time he probably has picked the rooms he wants.

About going to Eastern Washington, I can go anytime after the 15th. I have not been over there since Mr. Long and I were there in November of last year.

I want to go to Tacoma Thursday and will see you then.

Yours very truly,

A. G. Hanson

AGH: AH

WEYERHAEUSER TIMBER COMPANY
TACOMA, WASHINGTON

Oct. 24, 1930

Mr. O. W. Pierson
White River Lumber Co.
Enumclaw, Wash.

Dear Sir:

Release of mortgage, covering $N\frac{1}{2}$ of $NW\frac{1}{4}$ Sec. 22 Twp.
19 No. Rge. 8 East, should be sent to this office for submission
to our attorneys who will then pass on the sufficiency of the instru-
ment.

Very truly yours

GHT/r

Letter file

WHITE RIVER LUMBER COMPANY

ENUMCLAW, WASHINGTON

October 22, 1930

Weyerhaeuser Timber Co.
Tacoma,
Washington

Gentlemen: Attention Mr. Thomas

We believe that your attorneys have the deed to the N $\frac{1}{2}$ of the NW $\frac{1}{4}$ of Section 22, Township 19N, Range 8E.

There was a question raised as to the title and your attorneys made certain suggestions which we have now complied with. This is in the form of a release of mortgage. Will you kindly take it up with them and advise us whether we should forward the release to them or they simply return the deed to us upon receipt of which we would attach the release.

Yours very truly,

WHITE RIVER LUMBER COMPANY

By

O. W. Pierson

Accountant

OWP:AH



WHITE RIVER LUMBER COMPANY

ENUMCLAW, WASHINGTON

LETTER FILE

October 21, 1930



Weyerhaeuser Timber Co.
Tacoma,
Washington

Attention Mr. W. L. McCormick

Gentlemen:

Your letters of the 18th relative to the Hylebos Waterway improvement and the storage of logs by the Foss Launch Company and the Cascade Tug Boat Company have been received and will be called to Mr. Hanson's attention upon his return from the East.

Yours very truly,

WHITE RIVER LUMBER COMPANY

By

OWP
Accountant

OWP:AH

Wm P. Peitz

Tacoma, Washington, Sept. 20, 1930.

White River Lumber Company,
Enumclaw, Washington.

Gentlemen:

Attention Mr. Pierson.

Enclosed please find a dividend order signed by Mr. Chas. H. Ingram for the payment of any dividends hereafter declared upon certificate of stock No. 8 for one share issued in the name of Mr. Ingram, dividends to be paid to Weyerhaeuser Timber Company. Think you have dividend orders for the other qualifying trustees' shares, and this should be filed in the same place, and proper notation made that when any dividends are declared that a dividend payable on this one share of stock is to be included in the dividend check to the Weyerhaeuser Timber Company.

Very truly yours,

Enc.

WHITE RIVER LUMBER COMPANY

WLMcC-C

Wm P. Peitz

ORDER FOR DIVIDENDS

Tacoma, Washington, September 11, 1930.

To the Treasurer and other disbursing officers of

White River Lumber Company, Enumclaw, Washington.

I, the undersigned, hereby direct you to pay to the Weyerhaeuser Timber Company, a Washington corporation, all dividends which may accrue upon the shares of stock in White River Lumber Company, represented by that certain certificate of capital stock in said White River Lumber Company, issued to me, numbered 8 for one share of said capital stock.

The payment of dividends as hereby directed, is to be continued so long as said certificate remains outstanding in my name.

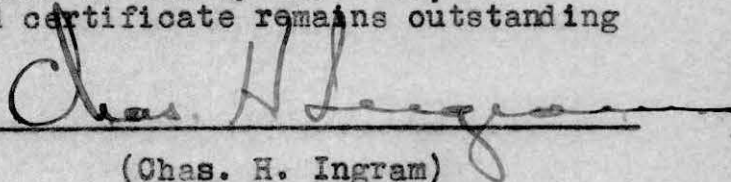

(Chas. H. Ingram)

*Duplicate attached to stub
of Stock Certificate #7*

WHITE RIVER LUMBER COMPANY

ENUMCLAW, WASHINGTON

September 16, 1930

Weyerhaeuser Timber Co.
Tacoma,
Washington

Attention Mr. A. D. Orr

Gentlemen:

Will you kindly forward us a good supply of
voucher cards as per enclosed sample.

Yours very truly,

WHITE RIVER LUMBER COMPANY

By *O. W. Pierson*
Accountant

OWP: AH

*450 Memo cards
mailed Sept 17-1930
vm
forwarded 9/18-30
ca*



WEYERHAEUSER TIMBER COMPANY
TACOMA. WASHINGTON

August 25th, 1930

Mr. F. ~~B.~~ Weyerhaeuser,
St. Paul, Minnesota.

Loan to
White River Lumber Company

Axel Hanson of the White River Lumber Company came in this morning and discussed the matter of finances for handling the construction which has been planned and is going on at Enumclaw.

As you know, we are moving the planing mill on to the flat above the present saw mill and complementing this with sorting chains, dry kilns and shipping sheds.

I assume that he is going to want about \$500,000.00 and unless you feel otherwise, we are inclined to loan this to him, taking notes from him as he borrows this money from us, charging him on the basis of 6%. He already owes us \$120,000.00 which was loaned him several months ago.

Mr. Hanson tells us he will probably want this on the basis of \$100,000.00 per month for the next five months, the first money that he will want being about the 10th of September.

I will be very pleased to have your reactions to this as soon as possible, so in case you do not want to go through with the suggestion I have made, it will be possible for Mr. Hanson to make arrangements on the outside.

Yours very truly,

FRT/m

White River

August 18th, 1930

Mr. F. R. Titcomb ✓

Mr. C. H. Ingram

Gentlemen:

I have just figured out an estimated sprinkled rate for the present White River plant at Ellenson. The estimated rate on the present plant is approximately 60¢ and on the insurance which we now carry we will make a saving of approximately \$10,000.00 per year.

I have given Mr. Onstad the estimated saving per year and recommended that at as early a date as possible this plant be sprinkled in order to secure this saving in insurance premium.

Yours very truly,



FBM:DB

Answer

WHITE RIVER LUMBER COMPANY

ENUMCLAW, WASHINGTON

August 14, 1930

Weyerhaeuser Timber Company
Tacoma, Washington

Gentlemen:

If you have the cruise of the timber
on the S.W. $\frac{1}{4}$ of the S.W. $\frac{1}{4}$ of Section 8-19-9,
we will appreciate having a copy of it.

Yours truly,

WHITE RIVER LUMBER COMPANY

A. G. Hanson

*Fir 2400
C 75
785

3,260*

AGH:h



WHITE RIVER LUMBER COMPANY

ENUMCLAW, WASHINGTON

July 30, 1930



Weyerhaeuser Timber Co.
Tacoma, Washington

Attention Mr. F. R. Titcomb

Gentlemen:

Mr. Hanson requests the writer to advise that we are fully covered on privately owned automobiles being used in the company's business.

Mr. Martin had us placed on the Weyerhaeuser policy covering Public Liability of \$50,000.00 to \$100,000.00.

Yours very truly,

WHITE RIVER LUMBER COMPANY

By

OW Purson
Accountant

OWP:AH

WHITE RIVER LUMBER COMPANY

ENUMCLAW, WASHINGTON

July 12, 1930

Weyerhaeuser Timber Company
Tacoma
Washington

Attention of Mr. F. B. Martin

Gentlemen:

Referring to yours of the 11th, relative to the employer's liability and public liability, will state that Mr. Obenour was here yesterday and we gave him pay rolls covering both up to June 30.

However, the pay rolls of our yards are in the Tacoma office, hence were not included in the figures given Mr. Obenour.

Yours very truly,

WHITE RIVER LUMBER COMPANY

By

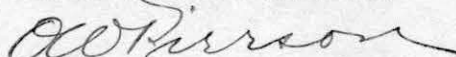

Accountant

OWP:L



WHITE RIVER LUMBER COMPANY

ENUMCLAW, WASHINGTON

July 12, 1930

Weyerhaeuser Timber Company
Tacoma
Washington

Attention of Mr. DeLong

Gentlemen:

We are in receipt of your letter of July 7 regarding the contract your affiliated companies have with A. B. Ewing of St. Louis, covering incandescent lamps.

Mr. Ewing wrote us some time ago regarding this contract and offered to include our company under the contract and we have agreed to do this.

We are glad to get the information that discounts have been increased 34% to 35% on standard packages and 24% to 25% on broken packages.

Thanking you for your interest and cooperation in this and other matters, we are

Yours very truly,

WHITE RIVER LUMBER COMPANY

C. G. Smith



CGS:L

Let's file

WHITE RIVER LUMBER COMPANY

ENUMCLAW, WASHINGTON

July 9, 1930

Weyerhaeuser Timber Company

Tacoma, Washington

Gentlemen: Attention of Mr. J. H. Thomas

We wish to acknowledge receipt of yours of July 8, enclosing bill of Hayden, Langhorne and Metzger for \$75.00, and wish to advise that we will make remittance direct to them.

Yours very truly,

WHITE RIVER LUMBER COMPANY

By

O. W. Purson
Accountant

OWP:L



WEYERHAEUSER TIMBER COMPANY
TACOMA, WASHINGTON

July 8, 1930.

*Letter
file*

White River Lumber Company,
Enumclaw, Washington.

Hayden, Langhorne & Metzger bill - Filling District #1.

Gentlemen:

We enclose herewith bill of Hayden, Langhorne & Metzger for their services in connection with Filling District #1 amounting to \$75.00, which payment has been okehed by Mr. McCormick. Will you please make remittance direct to Hayden, Langhorne & Metzger.

Mr. McCormick wishes me to advise you that this District is still the subject of some discussion in the City Council, particularly with a view to doing less filling than originally contemplated, but that no decision has yet been arrived at. We are keeping close watch on the matter.

Yours very truly,

WEYERHAEUSER TIMBER COMPANY

Enc.

GHT-C

WEYERHAEUSER TIMBER COMPANY
TACOMA, WASHINGTON

June 25, 1930.

Mr. Hanson
White River Lumber Co.
Enumclaw, Wash.

Line Air Products Co.
Contracts

I am passing on to you letter, together with sample contracts, which were received in this office this morning, which I believe will be of interest to your Mr. Smith.

These have to do with the oxygen and acetylene contracts with the Line Air Products Co. and our company and you are entitled to participate in same if you so desire.

Very truly yours

F.R. Titcomb:BR
enc.

Apparently the Assessor is segregating timber values to lands not heretofore carrying a timber assessment. For instance, the timber on rights-of-way over Sections 2, 3, 4 and 5 of Township 19 North of Range 8 East and Section 33, Township 20 North of Range 8 East has apparently been segregated from the timber on the entire section. This timber has always been taxed as a unit and the owner of the section has paid such taxes as real property. Inasmuch as you own the remainder of these sections, I would suggest that you ask the Assessor not to disturb the present assessment. By segregating the timber on the right-of-way which segregation must presumably be more or less arbitrary they make themselves a lot of work and can only gain the small amount of discount which they do not allow on personal property taxes. You would be saving more or less grief and work and would be ahead the discount allowed on real property taxes.

In the final analysis the White River Lumber Company is paying the tax on all of the timber in the section and it seems to me that the assessment to you should be simplified as much as possible.

If I may make the suggestion, believe the best way for you to handle this would be to make an appointment with Mr. Brown, the Timber Deputy, and endeavor to get the assessment as simple and as correct as possible. As a rule Mr. Brown spends most of his time in the field, but is in the office every Saturday morning. You will find him a very pleasant gentleman to deal with.

GHT/M
Enc.

Yours very truly,

WHITE RIVER LUMBER COMPANY

ENUMCLAW, WASHINGTON

June 17, 1930



Mr. F. R. Titcomb
Weyerhaeuser Timber Company
Tacoma, Washington

Dear Mr. Titcomb:

I was in hopes to see you today. It is such a nice day to look over things and if Mr. Long could have seen the congestion on the sorting table, it would have taken him just a few minutes to make up his mind that we need two tables.

Regarding past due accounts; we have some all the time but the final loss is negligible. For example, we did over a hundred thousand dollars in the retail department last year and we only lost nine dollars. We charged off \$2063.64 in the wholesale department in a business of over a million and a half. There were two concerns in Seattle that went bankrupt which caused nearly all this loss. One of these concerns tried to make handles and we were anxious to help them get started and I believe they would have succeeded if the manager had had ordinary ability. When I get back I hope you will come up and see us and hear our version of this question.

And by the way, Robbins' lease has expired and we are anxious to get in your building. It would be nice if we can get two rooms near your floors so we can drop in without using the elevator.

Mr. Olson will be down Thursday morning.

Sincerely yours,

A. H. Hanson

AGH:EL

WEYERHAEUSER TIMBER COMPANY
TACOMA, WASHINGTON

June 13, 1930

Mr. A. G. Hanson - Enumclaw, Wash

Past Due Accounts

As you know, we have a pretty complete credit department in the Weyerhaeuser organization and from time to time we notice that certain concerns tend to pyramid their accounts with our different operations, in fact, we found this situation to exist only recently with one of the concerns with whom we do business here on the Coast in our logging operations. Our credit department brought this to our attention and we were able to reduce his indebtedness very materially in a very short time which illustrated to him we were watching his account pretty carefully.

I have never seen one of your past due statements, and if you have no objections I would appreciate it if you would forward one down to me and we will check this over with our own list and let you know exactly what the status may be, as with all of our affiliated companies.

You may rest assured that neither ourselves or our sales organization will in any way take advantage of the information which you give us, and I am sure you will realize that anything we do along this line will be only for constructive reasons.

Yours very truly,

FRT/m

WHITE RIVER LUMBER CO.

ENUMCLAW, WASH. JUN 7 - 1930

Weyerhaeuser Lumber Co

Tacoma

Enclosed please find our check for \$ 75⁴⁰ in payment of bills as below. No receipt necessary.

Yours truly,

WHITE RIVER LUMBER CO.

DATE	INVOICE	Discount	BALANCE
22	1.66		
16	73.74		
	<u>75⁴⁰</u>		



June 4, 1930.

Mr. A. G. Hanson

White River Lumber Company
Enumclaw, Washington.

Dear Sir:

Sorry to have missed you yesterday when you were in our office for a brief period, but referring to your letter of May 31st, I note with interest the comment you make about your production during the month of May, your sales, etc. and will await with much interest the figures, which you will be able to get showing the cost of production when you run full time as contrasted with the cost when you run five days a week.

Also note your further comments about some of the outstanding obligations of the White River Lumber Company, and especially your desire or preference to clean up your outstanding timber contracts as soon as possible. As I understand it, the indebtedness to the Northern Pacific maturing October 26, 1931 of \$50,000.00 is drawing 6% and the indebtedness to the Oriental Land & Improvement Company, consisting of two notes each of \$100,000.00, is an indebtedness drawing 5%.

Also note that the Hanson Family company have something like \$125,000.00 which they are willing to loan to the White River Lumber Company, and the rate, of course, I presume should be at 6%.

Page #2 - Mr. Hanson

I can see clearly why borrowing from this fund at 6% would be worth while and cancel the Northern Pacific indebtedness of \$50,000.00 which likewise draws 6% but to borrow money at 6% to pay off an indebtedness to the Oriental Land & Improvement Company that carries a 5% rate of interest has no special attractions for the White River Lumber Company unless there is some particular reason of importance to want to get the Oriental Land & Improvement Company indebtedness cleared up as soon as possible.

The changes are that the improvements now under way in the rebuilding of your planing mill, dry kiln and lumber yard will require more funds than we are likely to take in for the sale of lumber and this means that White River Lumber Company will have to borrow some money before that job is completed and pay 6% for it so that unless there is some very special reason for getting the Oriental Land & Improvement Company indebtedness out of the way, I think we had better carry that along at 5% instead of borrowing money to pay it off on which we would have to pay 6%. However, it is very kind of you to offer to loan White River Lumber Company this \$125,000.00 and there is no question but what White River Lumber Company would be glad to take it over at 6% just as fast as they are in need of any money for ordinary receipts. In fact, if you are particularly anxious to place the Hanson money out at 6% at the present time, it will be entirely satisfactory for White River Lumber Company to take over this amount, pay off what is due the Northern Pacific and the

Page #3 - Mr. Hanson

and the residue of the fund can be applied to payment of the money due Weyerhaeuser Timber Company, which draws 6%, but I do not believe that I would pay off the Oriental Land & Improvement Co. indebtedness drawing 5% with money which I had to borrow at the rate of 6%.

By the way, whenever we do pay off the Northern Pacific we, of course, should remember to try and arrange to have the deed made in such a manner as will not embarrass us by any agreement we have relative to the guarantee on White River Lumber Company's part to see that the Northern Pacific gets all of the tonnage in that particular group of timber purchased from them. You will remember the discussions we had about this in the past and no doubt our Mr. Clapp, by personal interview with the officers in St. Paul, can arrange the matter to our entire satisfaction.

Very truly yours

WEYERHAEUSER TIMBER COMPANY

GSL/r

WHITE RIVER LUMBER COMPANY



ENUMCLAW, WASHINGTON

May 31, 1930

A large, stylized handwritten signature in dark ink, likely belonging to a representative of the White River Lumber Company.

Mr. George S. Long

Weyerhaeuser Timber Company

Tacoma, Washington

Dear Mr. Long:

We are closing the Month of May today and as we have made this month a test month, we are anxious to find out the outcome. For two years we have run only five days a week and we never knew how much it cost us. This month we run twenty-seven full days and cut seven and a half million feet. The cost should be a very fair average. The cost is what we like to know and it will take ten days before we will know. Our sales price will be very low, nearly five dollars less than a year ago. Orders are not coming in from the Southwest so we will be about twenty cars short of last month in shipments. The retail will be a half million feet and the average price is somewhat higher.

Collections are not quite as good as at the beginning of the year. At the first of May our outstanding account had increased \$85,000.00 and we paid one note to the Northern Pacific of \$50,000.00. We still owe the Northern Pacific on

this contract \$50,000.00 due August 26, 1931. I am very anxious to pay this note and have the deed. Oriental Land and Improvement Company hold two notes of a hundred thousand each which I had hoped to pay ere this. The first one is due November 11th this year and the last one a year later. If business had held up we would have had enough lumber to sell to pay up all this indebtedness.

The Hanson family have on hand around a hundred and twenty-five thousand dollars and if you approve of it, we would like to lend it to the White River Lumber Company so we can take up some of these notes. I will be in Tacoma Tuesday to the meeting and will come to your office in further conference in this matter.

I know you have been very busy this week so I have kept away from Tacoma since I got back.

Sincerely yours,

A.G. Hanson

A.G.Hanson:h

7
12/10

WHITE RIVER LUMBER COMPANY

ENUMCLAW, WASHINGTON.

May 2, 1930

Weyerhaeuser Timber Company
Tacoma, Washington

Gentlemen: Attention - Geo. S. Long, Jr.

We thank you for your letter of April 29th regarding orders for A. D. Davis of Portland which were through error, mailed to you. We also thank you for delivering the Fullerton invoice to Mr. Squiers who is in your building.

We are wondering if you received copies of the orders 24583 to 24591, or if they were sent to A. D. Davis Bureau.

We are mighty sorry this mistake happened and appreciate your assisting in straightening it out.

Very sincerely,

WHITE RIVER LUMBER COMPANY

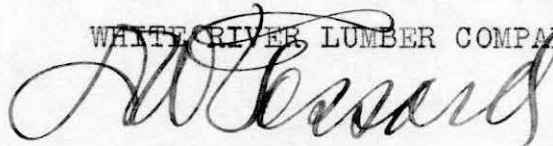

DWG:SH



WHITE RIVER LUMBER CO.

ENUMCLAW, WASH.. 4-12-30

Weyerhaeuser Lumber Co

Tacoma

Enclosed please find our check for \$ 8,267³⁴ in payment of bills as below. No receipt necessary.

Yours truly,

WHITE RIVER LUMBER CO.

DATE	INVOICE	Discount	BALANCE
<i>Cruising</i>	<i>6027.12</i>		
<i>Dec</i>	<i>2029.25</i>		
<i>Jan</i>	<i>93.74</i>		
<i>Feb</i>	<i>117.23</i>		
	<i>8267.34</i>		

*Check check 4/14
8/26/30
6/26/30*

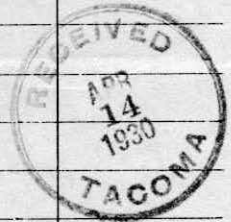

WHITE RIVER LUMBER COMPANY

ENUMCLAW, WASHINGTON

April 7, 1930

Mr. George S. Long

Weyerhaeuser Timber Company

Tacoma, Washington



Dear Mr. Long:

While you've been away and since I last wrote you I have had a meeting with the Milwaukee officials regarding the use of hemlock lumber. I heard that Mr. Gillick, the Senior Vice-President, was coming to the Coast so I wired him asking if I could have a meeting with him and discuss the use of hemlock for various purposes on the Milwaukee Railroad. He set ten o'clock in the morning, Wednesday March 12, in the office of the Western Traffic Manager in Seattle. He had assembled there the following officials:

Mr. J. T. Gillick, Vice-President

Mr. H. B. Earling, Vice-President

Mr. F. N. Hicks, Western Traffic Manager

Mr. C. B. Sanderson, Milwaukee Land Company

Mr. K. F. Nystrom, Supt. Car Building

Mr. J. T. Kelly, General Storekeeper

Mr. C. S. Finlayson, Purchasing Agent

Mr. R. J. Middleton, Maintenance Engineer

Mr. C. H. Budford, General Manager

WHITE RIVER LUMBER CO.

ENUMCLAW, WASH.,

3-21-30

Weyerhaeuser Lumber Co

Tacoma, Wash

Enclosed please find our check for \$ 1,564.98 in payment of bills as below. No receipt necessary.

Yours truly,

WHITE RIVER LUMBER CO.

DATE	INVOICE	Discount	BALANCE
<i>3/15</i> <i>Taxes</i>	<i>1,564.98</i>		



WEYERHAEUSER TIMBER COMPANY
TACOMA, WASHINGTON

February 25, 1930.

White River Lumber Company,
Enumclaw, Washington.

Gentlemen:

Attention Mr. Pierson.

Yours of the 21st enclosing the official receipt of the Secretary of State of the filing of the Articles of Incorporation of White River Lumber Company on December 17, 1929. This certificate will be filed in the minute book.

Very truly yours,

WLMcC-C

WEYERHAEUSER TIMBER COMPANY

Secretary.

Letterfile

WHITE RIVER LUMBER COMPANY

ENUMCLAW, WASHINGTON.



February 21, 1930

Weyerhaeuser Timber Co.
Tacoma, Washington

Attention Mr. McCormick

Gentlemen:

We are enclosing herewith registration notice of Articles of Incorporation of the White River Lumber Company which we presume you will want filed with the minute book.

Yours very truly,

WHITE RIVER LUMBER COMPANY

By

O. W. Peterson
Accountant

OWP: AH

WEYERHAEUSER TIMBER COMPANY
TACOMA, WASHINGTON

February 13, 1930

Mr. Geo. S. Long, Phoenix, Arizona

White River Lumber Company Taxes

On Tuesday we had our annual meeting of the White River Lumber Company at which time Mr. Hanson made the statement that he would have to borrow \$100,000.00 for his taxes.

It occurred to me at that time, as it has in the past, that it would be profitable for the Weyerhaeuser Timber Company, so long as it has available funds, to loan the White River Lumber Company money under the same terms and conditions as would exist should they get this money from the bank. This would mean at least $1\frac{1}{2}\%$ in excess of what we are now receiving and in a case like this would be a short time loan assuming of course that business conditions are going to pick up to the point where we can move our lumber more freely.

Looking at it in another light, we own something in excess of 60% of this company and necessarily would be paying out 60% of any interest money with which the White River Lumber Company was charged. I would appreciate it very much if you would give me your reactions to such a line and the policy which you think we should pursue in such instances.

Business is not picking up as fast as we had hoped, although our rail orders are coming in a little better each day.

WEYERHAEUSER TIMBER COMPANY
TACOMA, WASHINGTON

Mr. Long -2-

The Atlantic Coast has not been quite as active as we had hoped but Mr. Morris and I are going back to St. Paul to meet with the Colonel on Monday and Tuesday of next week to discuss our whole general eastern situation after which I will be glad to give you a more complete report of this situation if you are interested.

Yours very truly,

F.R. Titcomb/m

CC to

Mr. McCormick

February 1, 1930

Mr. A.G. Hanson
Enumelaw, Washington

Dear Mr. Hanson:

Again I wish to acknowledge receipt of your letter of January 21st enclosing statement of your December business, as well as your net results for the year 1929, which shows as I interpret it, a profit of \$225,154.82. I consider this showing a most excellent one, taking into consideration the large percentage of your product which is either Hemlock or White Fir or Noble Fir.

Of course, when another year rolls on, your company will have to pay a great deal heavier bill for taxes and the only way to offset this increased burden, will be either to get better prices for your lumber and likewise get a larger production. Of course, the production cannot be increased a very great deal until the time is right for a night run and not until we get your planing mill moved and a new yard established at the saw mill. However, we can cross the bridge when we come to it, but I am satisfied that if any lumber concern in western Washington can show a profit in the future, it is going to be your company.

I note your reference to the presence of Mr. Orr in your office, who together with your Office Manager, is arranging for a new set of books and proper entries, etc., and I think by the time they get through with this work they will find it quite satisfactory in every way and not very much more expensive to inaugurate and carry on than has been your system in the past.

Also feel that there are not any very serious problems ahead of either one of us in perfecting the titles which Mr. Metzger has called to our attention and that while it may take some little time to straighten out these matters, it will not

involve a very great deal of expense and will never amount to very much, if anything, that is serious.

We will have quite a bunch of loggers and lumbermen here in Phoenix. Among them is Mr. Bordeaux and his family and Mr. Alex Polson and his family, together with Mrs. Anderson of the firm of Anderson & Middleton, who by the way is the mother in law of young Mr. Polson's wife. Also Mr. Mark Reed and his wife expect to be here the last of this week and you tell me that you have been informed that Joe Irving and Governor Hartley are coming down, although I have not heard of this and rather doubt it. If Joe Irving and Hartley and Mark Reed and Alex Polson all get together down here, I am sure it will be an old fashioned bull fight before the crowd disburses, if one can judge by rumbles of ill feeling which has existed in this group during the past year or two.

I have been more than amazed by the weather you have had during January in western Washington and am especially disturbed over the situation down at Longview, where they have a foot of ice in the Columbia River. When it gets ready to go out we have \$100,000 worth of river improvements which will have to take a baptism worse than any I have ever heard of on Columbia River in the shape of floating ice and ice jams.

The weather down here is simply ideal and better than I expected to find it. So far this week it is very similar to the best week that you would have in Puget Sound country during either July or August, the highest temperature ranging from 65 to 74 and the lowest from 40 to 45 and with bright clear skies. How long it will remain that way is not a doubtful question with the people who live here and they say that February will be the best month in the year.

Kind regards to yourself and Mr. Polson and certainly to Mrs. Hanson, I am,

Yours very truly,

WHITE RIVER LUMBER COMPANY

ENUMCLAW, WASHINGTON. *Jan'y 21st 1930*

*Mr Geo S Long
Phoenix, Arizona.*

Dear Mr Long: Since you left for the south we have had terrible weather, east wind and cold weather. The log pond is frozen over with eight inches of ice. The sawmill been shut down three days but we started up again this morning. After new year orders commenced to come in but the bad weather during the last week shut off all orders. Our sheds are full of lumber and if we cant sell some of it I dont know what to do.

Mr Orr is up and with Mr Pierson he is trying to get our books together. Not being much of a bookkeeper I can give him little help.

George Jr said he will bring a load of abstracts up this week. We are working on the titles. Mr Metzger made a pretty bad report on our property disregarding both federal and state laws →

WHITE RIVER LUMBER COMPANY

ENUMCLAW, WASHINGTON.

I heard through Mr Sanderson that you will have distinguished visitors at Phoenix in a few weeks.

Governor Hartley and Joe Irving. Mr Sanderson intends to go down a little later.

I am inclosing our statement for the year. You may like to look it over while you are resting.

Sincerely yours,
A. G. Hanson

WHITE RIVER LUMBER COMPANY

ENUMCLAW, WASHINGTON, *Jan'y 31st 1930*

*Mr Geo S Long
Phoenix Arizona.*

Dear Mr Long

This is our yearly report that shows pretty well what we did last year. I have apologies to make for the pig department and the hotel. Orders are not coming in at all and I fear February will be bad. We shipped out only 119 Cars not enough to make expenses. Mr Orr and Mr Onstead were up yesterday and we went over the ground carefully with Mr Onstead. The cold weather has passed but the ice is eight inches thick on the pond.

*Sincerely yours
A. S. Hanson*

WHITE RIVER LUMBER COMPANY

ENUMCLAW, WASHINGTON.

January 27, 1930

Weyerhaeuser Timber Company

Tacoma, Washington

Gentlemen:

Attention - Mr. J. S. Abenour

We are enclosing two employee's statements which completes all of our employees.

Yours very truly,

WHITE RIVER LUMBER COMPANY

SH



WHITE RIVER LUMBER COMPANY

ENUNCLAW, WASHINGTON.

January 25, 1930

Weyerhaeuser Timber Company

Tacoma, Washington

Gentlemen: Attention - Mr. J. S. Abenour

We are inclosing employees statement of
A. B. Setterland. We still have one more to
send you as soon as we get it.

Yours truly,

WHITE RIVER LUMBER COMPANY

SH



WHITE RIVER LUMBER COMPANY

ENUMCLAW, WASHINGTON.

January 20, 1930

Weyerhaeuser Timber Company

Tacoma, Washington

Gentlemen: Attention - J. S. Abenour

We are enclosing six Employees Statements for fidelity bonds. We have yet a few to come from eastern Washington retail yards.

Yours truly,

WHITE RIVER LUMBER COMPANY

A. G. Hanson

AGH:SH



Letter file

January 17, 1930.

White River Lumber Co.
Enumclaw, Wash.

ATTENTION MR. O. W. PIERSON

In accordance with your request of January 16th, we are returning to you herewith 1928 King and Pierce Counties tax receipts.

We also enclose some opinions of Mr. H. H. Field rendered to the Oriental Land & Improvement Company many years ago which were attached to some of the abstracts submitted to our attorneys. These opinions are probably of no value to any one now but you may want to keep them in your files.

Very truly yours

GHT/r
enc.

WHITE RIVER LUMBER COMPANY

ENUMCLAW, WASHINGTON.

January 16, 1930

Weyerhaeuser Timber Co.
Tacoma, Washington

Attention Mr. Geo. S. Long, Jr.

Gentlemen:

For the monthly distribution of taxes we find that we are to separate the amount between timber lands and real estate. Hence, if our 1929 tax receipts have served your purpose, will you kindly return them as this is about the only way we can get a correct check on the distribution.

Yours very truly,

WHITE RIVER LUMBER COMPANY

By



Accountant

OWP:AH



WHITE RIVER LUMBER COMPANY

ENUMCLAW, WASHINGTON.

January 16, 1930

Mr. W. L. McCormick, Sec.

Weyerhaeuser Timber Company

Tacoma, Washington

Dear Sir:

We are enclosing check for \$40.70 in payment of money advance by your Company to the Auditors of King and Pierce Counties for recording deeds.

Yours very truly,

WHITE RIVER LUMBER COMPANY

A. G. Hanson
Vice President



AGH:SH

*Mr. Peetz
if correct amount
please ask who*

ORDER FOR DIVIDENDS

Enumclaw, Washington, January 6, 1930

To the Treasurer and other disbursing officers of

White River Lumber Company, Enumclaw, Washington:

I, the undersigned, hereby direct you to pay to the Weyerhaeuser Timber Company, a Washington corporation, all dividends which may accrue upon the shares of stock in White River Lumber Company, represented by that certain certificate of capital stock in said White River Lumber Company, issued to me, numbered 7 for one share of said capital stock.

The payment of dividends as hereby directed, is to be continued so long as said certificate remains outstanding in my name.



(F. R. Titcomb)

WEYERHAEUSER TIMBER COMPANY
TACOMA, WASHINGTON

Dec. 30, 1931

White River Lumber Company
Enumclaw, Washington

Mr. Pierson

Gentlemen:

Herewith we hand you the land book and document record of the White River Lumber Company and the following instruments:

Document #2 - Deed #1

Warranty Deed, Weyerhaeuser Timber Company to White River Lumber Company, dated Dec. 31, 1929, covering lands in Pierce and King Counties.

Document #4 - Deed #3

Warranty Deed from Hanson Timber Company to White River Lumber Company, dated Dec. 31, 1929, covering Tacoma property.

Document #5 - Deed #4

Warranty Deed from Hanson Timber Company to White River Lumber Company, dated Dec. 31, 1929, covering Lots 1, 2, 6 to 10, inc. in Block 7 and Lots 6 to 10, inc. in Block 8, Town of Ritzville, Wash.

Document #6 - Deed #5

Warranty Deed from Hanson Timber Company to White River Lumber Company, dated Dec. 31, 1929, covering Lots 1, 2 & 3, Block 4, Town of Schrag.

Document #7 - Deed #6

Warranty Deed from Hanson Timber Company to White River Lumber Company, dated Dec. 31, 1929, covering Lots 13 to 22, inc. Block 23, Town of White Bluffs and Blocks 78 & 79, Plat of Hanford.

Document #8 - Deed #7

Warranty Deed from Hanson Timber Company to

Page #2 - Mr. Pierson

Document #8-Deed #7 (cont'd.)

White River Lumber Company, dated Dec. 31, 1929, covering Lots 1 to 8, inclusive, Block 11, Plat of Pasco.

Document #9 - Deed #8

Warranty Deed from Hanson Timber Company to White River Lumber Company, dated Dec. 31, 1929, covering Tract 1, Wilson's Suburban Tracts.

Document #10 - Deed #9

Warranty Deed from Hanson Timber Company to White River Lumber Company, dated Dec. 31, 1929, covering Lots 1, 2 & 3, Block 27, Plat of The Townsite of Burbank.

Document #11 - Deed #10

Warranty Deed from Hanson Timber Company to White River Lumber Company, dated Dec. 31, 1929, covering Lots 1 to 16, inc., Block 31, Mabton Townsite Co's 2nd Addition and Mabton Garden Tracts and Lots 1 to 16, inc. Block 44, Plat of Grandview.

Document #37 - Land Contract #1

Assignment of timber land contract from the Hanson Timber Company to the White River Lumber Company, dated Dec. 31, 1929 and Deed #16, Warranty Deed from Oriental Land & Improvement Company to the White River Lumber Company, covering lands in Pierce and King Counties.

Document #40 - Land Contract #2

Assignment of timber land contract, Hanson Timber Company to White River Lumber Company, dated Dec. 31, 1929 and Deed #15, Warranty Deed from Northern Pacific Railway Company to White River Lumber Company covering lands in King and Pierce Counties.

Page #3 - Mr. Pierson

Document #41 - Bill of Sale #1

Hanson Timber Company to White River Lumber Company, dated Dec. 31, 1929.

Document #42 - Miscellaneous Contract #1

Title Guarantee from Hanson Timber Company, et al to White River Lumber Company, dated Dec. 31, 1929.

Document #43 - Deed #11

Warranty Deed from Ole Kure and wife to White River Lumber Company, dated Sept. 3, 1930, covering the SW $\frac{1}{4}$ of SW $\frac{1}{4}$ of Sec. 8-19-9E.

Document #45 - Deed #12

Quit Claim Deed from Harold W. Hanson and wife to White River Lumber Company, covering the W $\frac{1}{2}$ of NE $\frac{1}{4}$ of NE $\frac{1}{4}$ and part of the E $\frac{1}{2}$ of NW $\frac{1}{4}$ of NE $\frac{1}{4}$ of Sec. 33-20-7E.

Document #46 - Deed #13

Quit Claim Deed from Chicago, Milwaukee, St. Paul & Pacific Railroad Company to White River Lumber Company, dated June 5, 1931, covering certain rights of way in King County.

Document #47 - Deed #14

Warranty Deed from Edith Marie Berg to the White River Lumber Company, dated Aug. 3, 1931, covering Tract 20, Toman Addition to Enumclaw and Land Contract #3 from Edith Marie Berg to Erick Sander, dated June 1, 1931, covering the same property.

Document #49 - Right of Way #1

Right of Way easement granted by the Weyerhaeuser Timber Company to the United States Department of Agriculture covering right of way for telegraph or telephone line across the W $\frac{1}{2}$ of Sec. 11-19-9E.

Page # 4 - Mr. Pierson

Document #50 - Lease #1

Permit granted by the Weyerhaeuser Timber Company to United States Geological Survey covering part of the NW $\frac{1}{4}$ of NW $\frac{1}{4}$, Sec. 11, 19-9E.

Document #51 - Right of Way #2

Right of Way Deed from White River Lumber Company and the Mountain Development Company to the State of Washington, dated August 13, 1931, covering right of way of State Road #5.

Document #52 - Miscellaneous Contract #2

Agreement between State of Washington and the White River Lumber Company, dated August 13, 1931, covering the removal of stone and gravel from certain quarry sites and gravel borrow pit sites near right of way of State Road #5.

Document #54 - Miscellaneous Contract #3

Proposal from the Hanson Timber Company, et al to White River Lumber Company, dated Dec. 20, 1929.

Document #55 - Miscellaneous Contract #4

Liabilities Guarantee from White River Lumber Company to Hanson Timber Company, et al, dated Dec. 31, 1929.

Document #56 - Right of Way #3

Right of Way Deed from J. A. McKinnon and wife to the Town of Enumclaw, dated Aug. 30, 1915, covering right of way in Sec. 25-20-6E.

WEYERHAEUSER TIMBER COMPANY
TACOMA, WASHINGTON

Page # 5 - Mr. Pierson

Document #57 - Right of Way #4

Easement from the White River Lumber Company to Chicago, Milwaukee & St. Paul Railway Company, dated March 17, 1917, covering right of way in the NE $\frac{1}{4}$ of SE $\frac{1}{4}$ of Sec. 24-20-6E.

Document #58 - Right of Way #5

Right of Way Deed from White River Lumber Company to the Town of Enumclaw, dated July 17, 1923, covering right of way in Sec. 29-20-7E.

Document #59 - Sale Deed #2

Quit Claim Deed from White River Lumber Company to Mountain Development Company, dated Nov. 24, 1931, covering part of the NW $\frac{1}{4}$ of NW $\frac{1}{4}$ of Sec. 8-19N-8E.

Please acknowledge receipt of the above mentioned papers.

Very truly yours

WEYERHAEUSER TIMBER COMPANY

By 

JK/GHT/r
enc.

WEYERHAEUSER TIMBER COMPANY
TACOMA, WASHINGTON

Dec. 28, 1931

White River Lumber Company
Enumclaw, Washington

Mr. Pierson

Gentlemen:

We enclose herewith the following original Revenue Agent's reports of the White River Lumber Company and Hanson Timber Company:

White River Timber Company

Report dated July 1, 1927 covering years 1923 to 1925, inc.
" " Mar. 3, 1928 " " 1926 and 1927

Hanson Timber Company

Report dated Dec. 18, 1931 for year 1929

We have made copies of these reports and will retain them in our files for future use.

Very truly yours

WEYERHAEUSER TIMBER COMPANY

By 

JSO/r
enc.

WEYERHAEUSER TIMBER COMPANY
TACOMA, WASHINGTON

Dec. 15, 1931

White River Lumber Company
Enumclaw, Washington

Mr. Pierson

Gentlemen:

In checking over Revenue Agent's report covering year 1929 the writer discovers that he has not sufficient information available to make the necessary entries covering adjustments up to December 31st of that year.

In Exhibit A-1, sheet 5, of the above mentioned report you will note that item two refers to adjustments made by Revenue Agent in the years 1925, 1926 and 1927 together with entries made on your books to correct in 1928, and in order to make a journal entry intelligible it will be necessary for us to secure Revenue Agent's report covering these years. We believe you have this in your files and would ask that you forward it by return mail and upon receipt we will have a copy made for our files and return the original to you.

Please give this your early attention.

Very truly yours

WEYERHAEUSER TIMBER COMPANY

By 

J90/r

December 14, 1931.

Mr. A. G. Hanson - Enumclaw

Past Due Accounts

Thanks very much for your enclosure of recent date which I am returning, being Mr. Alden's letter of the 4th.

In regard to the matter of past due statements, I have the enclosed from Mr. Bidlake which is self-explanatory. I think if you could in the future get up for us a statement similar to the one which he outlines, it would not only be interesting to you, but to us here purely from the standpoint of checking past dues.

Totday more than ever before we have got to watch our accounts most closly, so I sincerely hope that you and your organization will do so and will call upon us at any time when you think we can be of any assistance, and we will be very glad to render you any help we can and this is one of the reasons for suggesting the outline such as Mr. Bidlake proposes.

I am rather startled at the amount of past due which you have in comparison with the volume of business you are doing. Just to give you an illustration, I might say to

WEYERHAEUSER TIMBER COMPANY
TACOMA. WASHINGTON

Mr. Hanson -2-

you that our own past dues amount to \$65,000.00 which covers shipments from Everett, Longview and Klamath Falls and which average around \$500,000.00 per month., In our case we have \$65,000.00 over 120 days as against your \$58,000.00. With kindest regards, I am

Yours very truly,

FRT/m

Enc. 2

WHITE RIVER LUMBER COMPANY

Detailed Balance Sheet

November 30, 1931



ASSETS

Current Assets			5,519,623.94
Available Funds		127,244.90	
Cash	183.58		
First Nat'l Bank - Enumclaw	6,047.04		
" " " Seattle	79.74		
Accounts Receivable	120,934.54		
Investments		2,999.30	
Land Contracts Rec.	2,835.00		
Enumclaw & Eastern Ry.	164.30		
Other Investments		7,100.00	
Lumber Inventories		467,293.61	
Lumber	462,431.93		
Shingles	2,757.04		
Lath	2,104.64		
Log Account		72,379.65	
Log Inventory	53,417.04		
Logs Felled & Bucked	18,962.61		
Other Current Inventories		9,265.95	
Store	3,259.28		
Hotel	589.46		
Carpenter Shop	573.61		
Horses	200.00		
Machine Shop Stores	902.23		
Saws	2,061.56		
Supplies	3,484.27		
Fire Insurance Prepaid		3,477.68	
Timber		4,836,818.21	

WHITE RIVER LUMBER COMPANY

Detailed Balance Sheet

November 30, 1931

Fixed Assets			3,357,325.93
Real Estate & Improvements		656,117.05	
Real Estate	359,935.45		
Farm	18,088.96		
Rental Property	86,997.75		
Retail Yards	191,094.89		
Plant Accounts		2,083,446.07	
Plant Bldgs	381,534.14		
Plant Equip.	592,325.55		
Additions 1931	1,109,586.38		
Other Fixed Assets		366,867.29	
Logging Equip.	128,920.46		
Sundry Equip.	10,805.39		
Autos	6,343.21		
Office Furn. & Fixts	4,462.18		
Logging Rail Road	227,141.44		
Rail Road Equip.		245,131.69	
Deferred Expenses		5,763.83	
Logging Equip. Repairs	567.04		
Rail Road Repairs	301.98		
Saw Mill Repairs	1,119.07		
Transit Freight	130.06		
Income Tax Paid 1930	3,645.68		
Total Assets			8,876,949.87

WHITE RIVER LUMBER COMPANY

Detailed Balance Sheet

November 30, 1931

LIABILITIES

Current Liabilities		
Accounts Payable		1,470,484.73
Accts & Contracts	1,421.32	
Vouchers Payable	14,991.06	
Bills Payable	1,413,000.00	
Pay Roll	19,919.31	
Stockholders Loans	21,153.04	
Reserves Payable		165,990.99
Reserve for Taxes	100,542.30	
Reserve for Interest	65,365.19	
Reserve for Bad Debts	83.50	
Capital & Surplus		7,240,474.15
Stumpage Reserve	133,429.68	
Reserve for Depreciation 1931	1,065,342.06	
" " " Prior	109,357.42	
Undivided Profits	98,433.56	
Profit & Loss	261,600.34	
Paid in Surplus	2,292,378.89	
Capital Stock	4,000,000.00	
Total Liabilities		8,876,949.87

WHITE RIVER LUMBER COMPANY

ENUMCLAW, WASHINGTON

November 14, 1931



Weyerhaeuser Timber Company
Tacoma Building
Tacoma, Washington

Attention: Mr. Obenour

Gentlemen:

As per our conversation yesterday we are enclosing our check payable to the American Insurance Agency for \$181.15 covering our invoice of November 6th.

Very truly yours

WHITE RIVER LUMBER COMPANY

A handwritten signature in cursive script that reads "O.W. Pearson".

Accountant

OWP: DT
Enc.
Copy to Mr. Barragar

A handwritten mark or signature in the bottom left corner, possibly initials.

WHITE RIVER LUMBER COMPANY

ENUMCLAW, WASHINGTON

November 10, 1931



Weyerhaeuser Timber Company
Tacoma Building
Tacoma, Washington

Attention: Mr. Obenour

Gentlemen:

We are in receipt of yours of the 9th enclosing American Insurance Agency's invoice of \$181.15 covering our manufacturers and contractors public liability and note your request that we forward you the check.

The American Insurance Company now have a debit balance of over \$300.00 with us and Mr. Barragar advises that there is another credit memorandum and another small bill coming and that they will send us a check for the difference.

They are including this \$181.15 in their account.

Very truly yours

WHITE RIVER LUMBER COMPANY

A handwritten signature in cursive script that reads "O. W. Pierson".

Accountant

OWP:DT

Copy to Mr. Barragar

Handwritten initials, possibly "JL", in the bottom left corner of the page.

WEYERHAEUSER TIMBER COMPANY
TACOMA. WASHINGTON

October 19th, 1931

White River Lumber Company

Attention Mr. O. W. Pierson

Complying with your request of the 16th,
we mailed you under separate cover Saturday the 17th,
the following blanks for monthly cost reports:

100	Comparative General Balance Sheets
100	Sheet #14 Yard & Dry Kiln Expense
100	Sheet #13 Pond & Saw Mill Expense
100	Blank forms per attached.

Yours very truly,

WEYERHAEUSER TIMBER COMPANY

BR;DB

WHITE RIVER LUMBER COMPANY

ENUMCLAW, WASHINGTON

October 16, 1931

Weyerhaeuser Timber Company
Tacoma Building
Tacoma, Washington

Attention: Mr. Orr

Gentlemen:

Will you kindly forward us the following blanks
for monthly cost reports:

100	Comparative General Balance Sheets ✓
100	Sheet #14 Yard & Dry Kiln Expense ✓
100	Sheet #13 Pond & Saw Mill Expense ✓
¹⁰⁰ 200	Blank forms per attached. ✓

Very truly yours

WHITE RIVER LUMBER COMPANY

W. Pirson

Accountant



OWP:DT
Enc.

Miauel. 10/17/31
10/17/31

WEYERHAEUSER TIMBER COMPANY
TACOMA, WASHINGTON

October 15, 1931

White River Lumber Company
Enumclaw, Washington

Mr. Pierson

Gentlemen:

Please be referred to your letter of October 13th, addressed to Mr. Orr, in which you ask us to return your copy of the Northern Pacific Railway Company land contract if it is in our office.

Our investigations show that the contract was delivered to Mr. Clapp and Mr. Hanson at the time they were arranging for the deed and presumably it is still in either Mr. Hanson or Mr. Clapp's possession.

Very truly yours

WEYERHAEUSER TIMBER COMPANY

By

GHT/r

WHITE RIVER LUMBER COMPANY

ENUMCLAW, WASHINGTON

October 13, 1931

Weyerhaeuser Timber Co.
Tacoma
Washington

Attention Mr. Orr

Gentlemen:

We have received the deed from the Northern Pacific Railway Company covering the purchase of their holdings in Township 19, Range 10 E and they have asked us to surrender our copy of the contract under which the purchase was made.

The writer delivered this contract to Mr. Hanson at the time that he, and, I believe, Mr. Clapp, were arranging for the deed. If this contract is in your office, will you kindly forward it to us that we may in turn send it to the Northern Pacific.

Yours truly,

WHITE RIVER LUMBER COMPANY

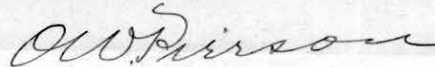

Accountant



OWP:PB

*Ans
10/13/31*

WEYERHAEUSER TIMBER COMPANY
TACOMA, WASHINGTON

October 8, 1931

White River Lumber Company
Enumclaw, Washington

Mr. Pierson

Gentlemen:

As requested in your letter of October 5th, we are today mailing you under separate cover 150 sheets of Form 33 - Operating Costs and Distribution on various equipment.

Very truly yours

WEYERHAEUSER TIMBER COMPANY

By

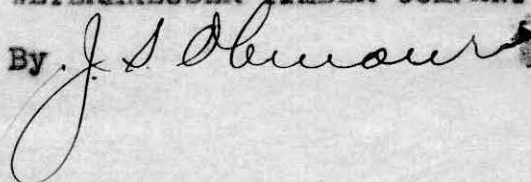

JSO/r

WHITE RIVER LUMBER COMPANY

ENUMCLAW, WASHINGTON

October 5, 1931

Weyerhaeuser Timber Company
Tacoma Building
Tacoma, Washington

Attention: Mr. Orr

Gentlemen:

Will you kindly forward us a supply of your Form 33--
Operating Costs and Distributions on various equipment.
We use about twelve per month. We will have the White
River Lumber Company printed instead of Weyerhaeuser
Timber Company, but no doubt we can get these a good
deal cheaper than if we had just a small amount
printed.

Yours very truly

WHITE RIVER LUMBER COMPANY

W. O. Pirson

Accountant

OMP:DT



*send
150 + bill*

WHITE RIVER LUMBER COMPANY

ENUMCLAW, WASHINGTON

October 5, 1931

Weyerhaeuser Timber Company
Tacoma Building
Tacoma, Washington

Attention: Mr. Obenour

Gentlemen:

We are enclosing our report on the public liability
and employees liability insurances for the month of
July, August and September inclusive.

Yours very truly

WHITE RIVER LUMBER COMPANY



Accountant

OWP:DT
Enc.



WHITE RIVER LUMBER COMPANY

ENUMCLAW, WASHINGTON

September 24, 1931

Mr. Minot Davis
Weverhaeuser Timber Company
Tacoma, Washington

Dear Sir:

In regard to the skidder which the Washington Iron Works are building for you, I believe it would be better to permit them to proceed with their original plan of construction.

They are convinced that it would give satisfaction and no doubt you also believe it would prove satisfactory, and I would not say that it wouldn't.

It probably will be better to let them build it along the lines of their original plans and after it is placed in operation you can soon tell whether it is efficient or not. If it is not, I will be very glad to recommend changes which I feel sure would improve its efficiency.

Yours very truly



LO:DT

WEYERHAEUSER TIMBER COMPANY
TACOMA, WASHINGTON

August 31st, 1931

Mr. G. H. Plummer,
Western Land Agent,
Northern Pacific Railway Co.,
Seattle, Washington.

Dear Mr. Plummer:

Thank you for your letter enclosing suggested form of letter to cover the matter of shipments of timber products from lands covered by contract with White River Lumber Company.

The substance of the letter which you have prepared is quite satisfactory, but I would like to have the letter show that the statement of the understanding is in lieu of the provision which is already in the contract. This can be accomplished in any way you desire. It could be done by changing the language in the clause of the letter reading "it is understood" so as to read somewhat as follows:-

"That contract contains a provision with reference to the shipment over the lines of Northern Pacific Railway Company of products manufactured from the timber upon the premises. You have made final payment on the contract and are about to receive a deed and are requesting that the understanding with reference to this subject be modified. In lieu of the clause on the same subject in the contract, it is understood that the following clause is a part of and one of the terms of said contract, and one

WEYERHAEUSER TIMBER COMPANY
TACOMA, WASHINGTON

-2-

of the considerations to the Northern Pacific Railway Company for said lands, without which said sale would not have been made, to-wit; " etc. as in your draft.

Yours very truly,

WEYERHAEUSER TIMBER COMPANY

AWO/M

WEYERHAEUSER TIMBER COMPANY
TACOMA, WASHINGTON

Tacoma, August 31, 1931

Mr. A. G. Hansen,
Enumclaw, Washington.

Dear Sir:

Enclosed I hand you a draft of a letter which I think you might write to the Milwaukee and Northern Pacific. I did not have Mr. Sloan's initials and you will have to insert those. Perhaps it would be better if you would wait until Mr. Buford gets home before sending in this letter because if the Northern Pacific gets it without Mr. Buford being there to take it up with them immediately, they will not know what it is all about. I think Mr. Buford said he would be home Sept. 6th.

I have talked with Mr. Ingram about this letter and if there is anything about it you want to take up over here, take it up with him.

Yours very truly,

AWC/M

WEYERHAEUSER TIMBER COMPANY
TACOMA, WASHINGTON

August 31, 1931

Mr. Geo. S. Long, Jr.
Office.

Transfer of Willapa Harbor Lumber Mills Stock.

Referring to the letter which you have received from Willapa Lumber Company, dated August 29th, inquiring as to the procedure to be followed to make proper transfer of stock in Willapa Harbor Lumber Mills from Sunset Timber Company to Willapa Lumber Company, you will find that in the guarantee contract between Willapa Lumber Company and Sunset Timber Company on the one hand and Willapa Harbor Lumber Mills on the other, it is provided that this stock may be transferred and that the depository may deliver the certificate that it holds for the sole purpose of having it transferred from Sunset Timber Company to Willapa Lumber Company.

This may be done, however, only if Sunset Timber Company presents the proper documentary evidence that it has been properly disincorporated and that it has legal right to transfer all of this stock to Willapa Lumber Company along with its other assets as a final liquidating dividend.

I am somewhat at a loss to know how Sunset Timber Company could have been wound up while it has outstanding, as I understand it, bonds under its general mortgage, and I suggest that you let Mr. Heidinger handle this and satisfy himself that Sunset Timber Company's proposed transfer to Willapa Lumber Co. is alright and is handled in accordance with the terms of the contract.

Yours very truly,

AWC/m

WHITE RIVER LUMBER COMPANY

ENUMCLAW WASHINGTON

Aug 16th 1931.

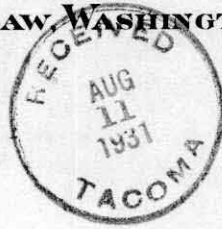

Mr Geo J Lang Jr

Tacoma Wash

Dear Rod:

I am enclosing the oath
of trustees of the Enumclaw & Eastern
Ry Co which I hope you find
in order. 1500 cars went into
the park yesterday through the North
East gate.

Sincerely yours

A. G. Hanson

WHITE RIVER LUMBER COMPANY

ENUMCLAW, WASHINGTON

August 15, 1931

Mr. F. R. Titcomb, General Manager
Weyerhaeuser Timber Company
Tacoma, Washington

Dear Mr. Titcomb:

On your desk will come shortly the July report. You will notice our loss for the month of July to be \$25,770.01.

We intended to spread the fire loss over the year but Mr. Halliday wanted it all taken to account in one month. He also wanted our inventory reduced to cost. All of this made a very bad statement. These are the main deductions:

Fire loss	13,648.60
Timber Land Taxes	5,861.10
Interest on New Mill	5,883.84
Deduction on Inventory	<u>2,807.69</u>
	\$ 28,201.23



Yours truly,

A. G. Hanson

A. G. Hanson:sh

WEYERHAEUSER TIMBER COMPANY
TACOMA, WASHINGTON

August 12, 1931

White River Lumber Co.

Enumclaw, Washington

Mr. Pierson

Gentlemen:

We have your letter of August 8th enclosing
note signed by Mr. Hanson.

We have secured Mr. McCormick's signature on
this note.

Very truly yours

WEYERHAEUSER TIMBER COMPANY

By 

ADO/r

Letter file

WHITE RIVER LUMBER COMPANY

ENUMCLAW, WASHINGTON

August 8, 1931



Weyerhaeuser Timber Company

Tacoma, Washington

Attention Mr. Orr

Gentlemen:

We are returning herewith our note of August 8 properly signed by Mr. Hanson.

Yours truly,

WHITE RIVER LUMBER COMPANY

O. W. Pierson

Accountant

OWP:PB

Enc. 1

WEYERHAEUSER TIMBER COMPANY
TACOMA, WASHINGTON

August 7, 1931

White River Lumber Company
Enumclaw, Washington

Mr. A. G. Hanson

Gentlemen:

In accordance with your telephone conversation with Mr. McCormick, we enclose herewith our check for \$20,000.00. We also enclose note for this amount dated August 8th. Will you kindly sign the original, returning same to this office. The copy is for your files.

Very truly yours

WEYERHAEUSER TIMBER COMPANY

By 

ADO/r
enc.

WHITE RIVER LUMBER COMPANY

M. Lamb

ENUMCLAW, WASHINGTON

Aug 10th 1931

LETTER FILE

Mr F R Titcomb.

Tacoma Wash.



Dear Rod:

I cut the enclosed clippings out of yesterdays P. D. The Governor will have a big job on his hands to stop us but as a precaution our legal department better be informed about it.

There were 1500 cars registered at the park yesterday.

Sincerely yours
A. S. Hanson

HARTLEY WOULD SAVE FORESTS

By E. E. FUSSELL

Post-Intelligencer Staff Correspondent

WITH THE CONGRESSIONAL PARTY, Sunrise, Rainier National Park, Aug. 8.—Lumbermen, spare those trees!

This is the mission of Governor Hartley as he left the congressional party here, after accompanying it from Seattle.

Himself a lumberman and many times a critic of federal conservation policies, the governor became an apostle of the "save-the-trees" movement, as he saw logging operations started a short distance east of Enumclaw in the heavy standing timber lining the National Park Highway.

S. H. Hedges, president of the Washington State Chamber of Commerce, and Asahel Curtis, chairman of the Rainier National Park advisory board, when the party arrived here urged the advantage of saving this timber, among the finest lining any highway in the state. They found the governor already a convert to the plan.

"I am going back to Olympia immediately, see who owns the land, and ask the attorney general if the state has power, without waiting for any new laws, to save it," the governor said.

Japanese Police

CONGRESSMEN USE NEW PASS

YAKIMA, Aug. 8.—(Special)—

Visiting congressmen and their escorts from Seattle and Yakima today composed the first auto party to cross the Cascades over the new Naches Pass State Highway. The car containing Congressman W. W. Hastings, Oklahoma, was forced off the road and wrecked, but all occupants escaped injury.

Passengers of some cars got out and pushed at one steep and narrow point. But travelers generally agreed the new road, when completed late this fall, will rank as one of Washington's most scenic highways and do wonders to unite the two halves of the state.

Yakima and Seattle are 160 miles apart in the new route. Each is ninety-three miles from Sunrise, the new resort area in the northeast corner of Rainier National Park. The road is already open between Seattle and Sunrise.

WEYERHAEUSER TIMBER COMPANY
TACOMA, WASHINGTON

August 7th, 1931

Mr. A. G. Hanson
White River Lumber Company
Enumclaw, Washington.

Your note of August 7th. Mr. Orr will send you remittance for Twenty Thousand (\$20,000) for Monday's payroll as requested, with a note to be signed and returned.

The special meeting of the stockholders called for Monday, of the Eunclaw & Eastern Railway Company, is purely formal and the Minutes will be written up here and the next time you are over you can sign them.

I think George will send you the blank Oath of Office for Trustees to sign before a Notary Public.

Very truly yours,



WLMc:H

G.S.H. jr

WHITE RIVER LUMBER COMPANY

ENUMCLAW, WASHINGTON

Aug 7th 1931

Mr W. L. McCormick
Tacoma Wash

Dear Bill:

Collections for last month have been slow and I find we are going to be short for payday on Monday. Can you spare us twenty thousand dollars.

Are Lou and I supposed to be at the meeting of E x E Ry Monday.

Sincerely yours
A.T. Hanson

WEYERHAEUSER TIMBER COMPANY
TACOMA, WASHINGTON

July 29, 1931

White River Lumber Co.

Enumclaw, Wash.

Gentlemen:

We are mailing you today under separate cover
^{Blank} 250 monthly operating statement forms as requested in your
letter of July 15th.

We regret the delay in mailing these forms to
you but thru some misunderstanding the matter was over-looked.

Very truly yours

WEYERHAEUSER TIMBER COMPANY

By

ADO/MM

WHITE RIVER LUMBER COMPANY

ENUMCLAW, WASHINGTON

July 28, 1931

Weyerhaeuser Timber Company

Tacoma, Washington

Attention Mr. Orr

Gentlemen:

We have not yet received the blank sheets for the monthly operating statement which we requested July 15.

We will need a supply of these for our next monthly report as we are entirely out.

Yours truly,

WHITE RIVER LUMBER COMPANY

O. W. Parison

Accountant

OWP:PB



*Mailed
750 sheets
July 27, 1931*

WHITE RIVER LUMBER COMPANY

ENUMCLAW, WASHINGTON

July 15, 1931



Weyerhaeuser Timber Co.
Tacoma
Washington

Attention Mr. Orr

Gentlemen:

Will you kindly forward us a supply of blank sheets for our monthly operating statements.

Yours truly,

WHITE RIVER LUMBER COMPANY

OW Pinson

Accountant

OWP:PB

*See letter 7-28
for date mailed*

WEYERHAEUSER TIMBER COMPANY
TACOMA, WASHINGTON

July 14, 1931

White River Lumber Company
Enumclaw, Washington

Gentlemen:

We enclose herewith copies of your notes as follows:

Dated	Sept.	8,	1930	\$100,000.00
"	Nov.	6,	1930	200,000.00
"	Dec.	9,	1930	100,000.00
"	Dec.	22,	1930	200,000.00
"	Feb.	10,	1931	150,000.00
"	Mch.	10,	1931	200,000.00
"	Mch.	14,	1931	180,000.00
"	Apr.	10,	1931	50,000.00
"	May	8,	1931	<u>40,000.00</u>
	Total			\$1,220,000.00

which notes were made to replace your notes

Dated	Mch.	10,	1930	50,000.00
"	Mch.	14,	"	80,000.00
"	Sept.	8,	"	100,000.00
"	Nov.	6,	"	200,000.00
"	Dec.	9,	"	100,000.00
"	Dec.	22,	"	200,000.00
"	Feb.	10,	1931	150,000.00
"	Mch.	10,	"	150,000.00
"	Mch.	14,	"	100,000.00
"	Apr.	10,	"	50,000.00
"	May	8,	"	40,000.00

and which are returned herewith, cancelled.

Whenever you may have funds to apply on these notes, we suggest that payments of interest and principal be made on the first maturing note, the intention being to have you take these notes up in their regular order.

Very truly yours

WEYERHAEUSER TIMBER COMPANY

By  Cashier

JRP/r
enc.

WEYERHAEUSER TIMBER COMPANY
TACOMA, WASHINGTON

July 3, 1931

White River Lumber Co.
Enumclaw, Wash.

Mr. Pierson

Gentlemen:

We have your letter of July 2nd enclosing the
nine notes which have been signed by Mr. A. G. Hanson.

Mr. McCormick is out of the city for a week and
we will secure his signature on his return and send you the
original notes which these present notes replace.

Very truly yours

WEYERHAEUSER TIMBER COMPANY

By 

ADO/r

WHITE RIVER LUMBER COMPANY

ENUMCLAW, WASHINGTON

July 2, 1931



Weyerhaeuser Timber Co.
Tacoma
Washington

Attention Mr. Orr

Gentlemen:

As per yours of June 29 for the attention of Mr. Hanson, we are returning herewith the nine notes properly signed by Mr. Hanson.

Kindly forward us the old notes, cancelled.

Yours truly,

WHITE RIVER LUMBER COMPANY

O. O. Purison

Accountant

OWP:PB
Enc. 9

WEYERHAEUSER TIMBER COMPANY
TACOMA, WASHINGTON

June 29, 1931

White River Lumber Company
Enumclaw, Washington

Mr. A. G. Hanson

Gentlemen:

We enclose herewith 9 notes prepared on the new form about which I talked with you sometime ago. These notes will be used to take up the present notes in our files and you will note that they agree as to dates and amounts therewith.

There were two notes dated March 10th and March 14th, 1930 for \$50,000.00 and \$80,000.00 respectively. The interest on these two notes was paid for one year and we have, therefore, combined these two amounts with notes issued March 10, 1931 and March 14, 1931 in the amount of \$150,000.00 and \$100,000.00 respectively.

Will you kindly sign the enclosed notes, returning same to our office and we will secure the signature of Mr. McCormick. After these notes have been completed, we will return to you the former cancelled notes.

Very truly yours

WEYERHAEUSER TIMBER COMPANY

By 

ADO/r
enc.

WEYERHAEUSER TIMBER COMPANY
TACOMA, WASHINGTON

July 13, 1931

Mr. Louis Olson - Enumclaw

Equalizing Device

I was very much impressed with the equalizing device which you have behind your green matcher. There are one or two questions I would like to ask you having to do with this machine, which to my mind are important from the standpoint of some of our other fast feed machines.

Have you operated your matcher at 600 feet per minute on 2 x 4, as an example, with this attachment?

If so what were the results with your equalizing device?

Thanking you in advance, I am

Yours very truly,

FRT/m

WEYERHAEUSER TIMBER COMPANY
TACOMA, WASHINGTON

June 16, 1931

White River Lumber Company
Enumclaw, Washington

We are enclosing herewith copy of formal protest to be used in connection with payments made to the Department of Labor and Industries covering the 1% assessment on the 1930 payrolls. We would ask that you use the enclosed form to transmit your remittances to the department on your own letterheads.

Yours very truly,

JSO/mja
enc.

file

WHITE RIVER LUMBER COMPANY

ENUMCLAW, WASHINGTON

June 9, 1931

Weyerhaeuser Timber Co.
Tacoma
Washington

Attention Mr. Geo. S. Long Jr.

Gentlemen:

We wish to thank you for yours of the 8th for the attention of Mr. Olson, enclosing a copy of your latest right-of-way deeds to the State of Washington. No doubt, we will have use for this in the very near future.

Yours very truly,

WHITE RIVER LUMBER COMPANY

O. W. Purison

Accountant

OWP:PB



file

WHITE RIVER LUMBER COMPANY

ENUMCLAW, WASHINGTON.

June 8th 1931

Mr W. L. McCormick

Second week.

Dear Bill:

I enclose my proxy
for voting my stock on June 29th.
This seems to me a move in the
right direction.

If Mr Ingram will be
in his office Wednesday afternoon
I will be down to see you regarding
the state right of way up White
River.

Love Friday



Sincerely
A. G. Hanson

WEYERHAEUSER TIMBER COMPANY
TACOMA, WASHINGTON

June 1st, 1931

Mr. A. G. Hanson
White River Lumber Co.
Enumclaw, Washington

Dear Mr. Hanson:

Referring to the conversation that we had several days ago about the possibility that you might haul over your logging railroad a steam shovel or road machinery or something, for the State or for a contractor, to be used in the construction of a state road through your holdings. I want to suggest that, if practicable in this case and in all cases where you and Mr. Titcomb think that there is a good reason why you should transport property for the State or for the government, you write a letter somewhat along the following lines:

"We are writing you with reference to the arrangement made to transport over our logging railroad (whatever it is - shovel, road machinery or material) to be used in the construction of State Road # . As you know, our railroad is not a common carrier. We have agreed to furnish this particular transportation service for you not on account of the revenue involved, but because in this particular instance we believe we are not only performing a public service but one of substantial benefit to our company. Our action must not be taken as a precedent or as indicating a willingness to transport property for others or for you except in exceptional cases, each one of which must be considered by itself."

Yours very truly,

AWC:DB

Mr. G. Hanson

June 1st, 1931

Mr. G. Hanson
White River Lumber Co.
Bannock, Washington

Dear Mr. Hanson:

Referring to the conversation that we had several days ago about the possibility that you might haul over your logging railroad a steam shovel or road machinery or something, for the State or for a contractor, to be used in the construction of a state road through your holdings. I want to suggest that it is practicable in this case and in all cases where you and Mr. Titcomb think that there is a good reason why you should transport property for the State or for the Government, you write a letter somewhat along the

following lines:

"We are writing you with reference to the arrangement made to transport over our logging railroad (whatever it is - shovel, road machinery or material) to be used in the construction of State Road # . . . As you know, our railroad is not a common carrier. We have agreed to furnish this particular transportation service for you not on account of the revenue involved, but because in this particular instance we believe we are not only performing a public service but one of substantial benefit to our company. Our action must not be taken as a precedent or as indicating a willingness to transport property for others or for you except in exceptional cases, each one of which must be considered by itself."

Yours very truly,

WEL:UB

WEYERHAEUSER TIMBER COMPANY
TACOMA, WASHINGTON

May 25th, 1931

Mr. *A. G.* Hanson
White River Lumber Company
Enumclaw, Washington.

Dear Mr. Hanson:

Answering your letter of May 21st regarding the right-of-way for the new White River Highway, I believe that Mr. Ingram and Mr. Firmin probably have the very information which you are after. Mr. Ingram was at Snoqualmie Falls at the time they had most of their dealings with the Highway Department, and Mr. Firmin also had a lot to do with the right-of-way matter. I imagine that you will probably be down here some time in the near future, and will have a chance to talk to both of these gentlemen.

Mr. McVicar, the State Right-of-Way man was in the office last week regarding right-of-way over the Mountain Development Company property, and at that time we told him that the timber on the Mountain Development Company land was all owned by the White River Lumber Company, and so the disposal of it would be handled by your office.

I was interested in seeing the estimated cost of the change from Scatter Creek on, and I certainly hope that the state will be agreeable to this change and agreeable to assuming part of these costs. I tried to see Mr. Shearer several times in Seattle, but have never been lucky enough to catch him in the office.

Yours very truly,

GSL, Jr.
H.

WHITE RIVER LUMBER COMPANY

ENUMCLAW, WASHINGTON

May 21, 1931

Mr. George S. Long
Weyerhaeuser Timber Company
Tacoma, Washington



Dear George:

Before long we shall have the problem before us to settle with the State for right of way of their White River Highway. It will be in the neighborhood of twenty-five miles. There will be much rebuilding to be done besides the widening of the road.

Someone in your organization must have negotiated for the right of way of the Snoqualmie road. I would like very much to get in touch with the man who dealt with the State for this right of way and be able to post up on what I am liable to encounter with the State right of way agent.

We have figured the cost to change the grade from Scatter Creek to the crossing of our road and the highway in Section 6-19-8; the engineers figure is \$17108.24. Hope the State will see it the same way.

Yours truly,

A. G. Hanson

A.G.Hanson:sh

WHITE RIVER LUMBER COMPANY

ENUMCLAW, WASHINGTON

May 20th 1931

Mr W.L. McCormick

Tacoma Wash.

LETTER FILE

Dear Bill.

Thanks for making me a partner.

I am enclosing the proxy but perhaps I will be there in person. The receipt for certificate 1492 is also enclosed.

Here is hopes that all goes

well.

Sincerely yours
A.S. Hanson.



WEYERHAEUSER TIMBER COMPANY
TACOMA, WASHINGTON

May 12, 1931

White River Lumber Company
Enumclaw, Washington

Attention Mr. A. G. Hanson

Gentlemen:

On the 8th inst. we sent you check for \$40,000.00 also note for like amount to be signed by you.

In drawing up this note, the date was erroneously written April 8, 1931 instead of May 8, 1931 and at the request of Mr. McCormick we have changed the date to May 8th and suggest that you change your record to agree with the corrected date.

Very truly yours

WEYERHAEUSER TIMBER COMPANY

By

Cashier

JRP/r

WEYERHAEUSER TIMBER COMPANY
TACOMA, WASHINGTON

May 9, 1931

White River Lumber Company
Enumclaw, Washington

ATTENTION MR. O. W. Pierson

Gentlemen:

The Weyerhaeuser Timber Company did not pay the taxes on that part of Lot 5 lying South of the Green Water River in Sec. 3, Twp. 19 No., Rge. 9 East.

Very truly yours

WEYERHAEUSER TIMBER COMPANY

By

GHT/r

*Letts
Pitt*

WHITE RIVER LUMBER COMPANY

ENUMCLAW, WASHINGTON

May 8, 1931

Weyerhaeuser Timber Co.
Tacoma,
Washington

Attention Mr. G. H. Thomas

Gentlemen:

Kindly advise whether the Weyerhaeuser Timber Company paid taxes on lot 5 South of Greenwater River in Pierce County, Sec. 3-19-9.

We received no tax statement covering this and unless you have paid it we will take it up with the County Treasurer of Pierce County for a statement.

Yours very truly,

WHITE RIVER LUMBER COMPANY

By

W. Purson

Accountant

OWP: ah



*Just
Did we?*

TACOMA

April 23, 1931

Weter, Roberts, & Shefelman
Northern Life Tower
Seattle, Washington

Gentlemen:

In accordance with the request of the White
River Lumber Company we are enclosing assignment
which has been signed by the President and Secretary
of this Company.

Yours very truly

WHITE RIVER LUMBER COMPANY

GSL, Jr:MM
ENC: 1
CC: Mr. O. W. Pierson

WEYERHAEUSER TIMBER COMPANY
TACOMA, WASHINGTON

April 17, 1931.

White River Lumber Company,
Enumclaw, Washington.

Gentlemen:

Mr. Pierson.

This acknowledges your letter of April 16th enclosing an assignment of your claim of \$751.45 against the Pearson Construction Company to the United States Fidelity & Guaranty Company.

Mr. Titcomb will be home Monday or Tuesday of next week and will then sign this, and we will forward it at that time to Weter, Roberts & Shefelman, Northern Life Tower, as requested.

Very truly yours,

WLMcC-C

WEYERHAEUSER TIMBER COMPANY

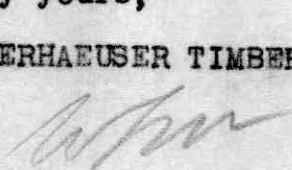
Secretary.

WHITE RIVER LUMBER COMPANY

ENUMCLAW, WASHINGTON

April 16, 1931

Weyerhaeuser Timber Co.
Tacoma,
Washington



Attention Mr. W. L. McCormick

Gentlemen:

We are enclosing an assignment of our claim in the amount of \$751.45 against the Pearson Construction Company to the United States Fidelity & Guaranty Company.

Weter, Roberts & Shefelman forwarded us this under date of April 13 together with draft for this amount. This account was placed with them by Mr. Robbins of our retail yards. We wrote them under date of the 14th that Mr. Hanson is out of the city for two weeks and they are now asking that we have the assignment signed by the President and Secretary and return to them as they are very anxious to close the deal.

Would you kindly get Mr. Titcomb's signature and affix your own and mail to Weter, Roberts & Shefelman, Northern Life Tower, Seattle.

Yours very truly,

WHITE RIVER LUMBER COMPANY

By

Accountant

*Geo - Big your Detroit
copy Rese
acknowledgement
mail to above
copy to Enumclaw*

OWP:ah

WHITE RIVER LUMBER COMPANY

ENUMCLAW, WASHINGTON. Apr 10th 1931

Mr W. L. McCormick
Tacoma Wash



Dear Mr McCormick:

We received the check for \$50,000- and I am enclosing the note for same amount. Thanks.

Mr Litcomb mentioned White River Valley Rail Road. White River Rail Road Co would be shorter but any name suits me

Low and I are figuring on going to Tacoma Saturday Morning to talk things over with all of you. We are not getting as many orders as we should. I hope you do better.

Sincerely yours
A. G. Hanson

WEYERHAEUSER TIMBER COMPANY
TACOMA, WASHINGTON

April 9, 1931

White River Lumber Company
Enumclaw, Washington

Attention Mr. Hanson

Gentlemen:

We enclose herewith our check for \$50,000.00, also note for like amount dated April 10th. This in accordance with your request of April 8th.

Kindly have the enclosed note signed and returned to this office at your earliest convenience.

Very truly yours

WEYERHAEUSER TIMBER COMPANY

By 

ADO/r ✓
enc. ✓

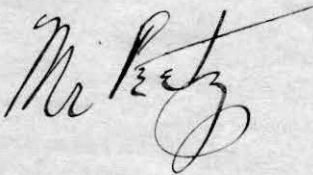

Mr Orr

WHITE RIVER LUMBER COMPANY

ENUMCLAW, WASHINGTON. Apr 8th 1931

Mr W.L. McCormick
Tacoma Wash

Dear Mr McCormick:

We started our mill Monday

Morning and the machinery functions very well. The men were all up the air not being used to the new things. It will take a little time to get them used to it.

We are not getting the orders we anticipated so money is scarce and the builders are springing new bills on me all the time. We need \$50,000 on the tenth to pay for labor and material on the new mill. The regular business is taking care of itself

I have not been able to get down to Tacoma while we are breaking in the men. Will see you in Seattle

Friday Night

Sincerely yours
A.G. Hanson

ack 4/8/31 -
Mr Orr miss send etc -

WEYERHAEUSER TIMBER COMPANY
TACOMA, WASHINGTON

April 8, 1931

White River Lumber Co.
Enumclaw, Washington

Attention Mr. Pierson

Gentlemen:

When you sent in your tentative income tax return for the year 1930 you failed to furnish us with a copy of the same and we neglected to make a copy in this office, so we are enclosing herewith blanks and request that you prepare a copy and forward to us to complete our files.

Very truly yours

WEYERHAEUSER TIMBER COMPANY

By

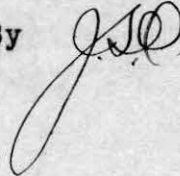

JSO/r
enc.

March

WEYERHAEUSER TIMBER COMPANY
TACOMA, WASHINGTON

March 25, 1931

White River Lumber Company
Enumclaw, Washington

Gentlemen:

We are sending you today under separate cover 100 distribution ledger sheets, form T-110, as per your letter of March 24th.

Very truly yours

WEYERHAEUSER TIMBER COMPANY

By *A. W. King*

ADO/MM

WHITE RIVER LUMBER COMPANY

ENUMCLAW, WASHINGTON

March 14, 1931

Weyerhaeuser Timber Co.
Tacoma,
Washington

Gentlemen:

As per yours of the 9th by Mr. J. A. Reeder we
are enclosing our check for \$67.56 being the
taxes on lot 3, Section 34-20-8, less 3%.

Yours very truly,

WHITE RIVER LUMBER COMPANY

By

O. W. Parison

Accountant

Inc 69.65
209

3%

67.56

OWP: AH



WHITE RIVER LUMBER COMPANY

ENUMCLAW, WASHINGTON

LETTER FILE

March 13, 1931

Weyerhaeuser Timber Co.
Tacoma,
Washington

Attention Mr. W. L. McCormick

Gentlemen:

This to acknowledge receipt of the return of
Mr. Titcomb's oath of office and to advise that
same has been pasted on page 66 of the minute
book.

Yours very truly,

WHITE RIVER LUMBER COMPANY

By *OW Purson*
Accountant.

OWP: AH



Tacoma,

XXXXXXXXXX

March 10, 1931.

White River Lumber Company,
Enumclaw, Washington.

Gentlemen:

Mr. Pierson.

We return herewith the oath of trustee of Mr. Titcomb which you sent us with your letter of March 9th.

The corporate seal has been affixed, and this oath of office is to be pasted in the minute book in your office on page 66.

Very truly yours,

Enc.

WLMcC-C

WHITE RIVER LUMBER COMPANY



Secretary.

WHITE RIVER LUMBER COMPANY

ENUMCLAW, WASHINGTON



March 9, 1931

LETTER FILE

Weyerhaeuser Timber Co.
Tacoma,
Washington

Attention Mr. W. L. McCormick

Gentlemen:

As per yours of the 7th, we are returning here-
with Mr. Titcomb's oath of office to affix the
impression of the Notary Public seal.

Yours very truly,

WHITE RIVER LUMBER COMPANY

By

A handwritten signature in cursive script, appearing to read "O. W. Pearson".

Asst. Sec.

OWP:ah

WHITE RIVER LUMBER COMPANY

ENUMCLAW, WASHINGTON

March 10, 1931

Weyerhaeuser Timber Co.
Tacoma,
Washington

Gentlemen:

We are enclosing our check for \$3,000.00 being
the interest for one year on our note of \$50,000.00
dated March 10, 1930.

Yours very truly,

WHITE RIVER LUMBER COMPANY

By

Old Purson
Accountant

OWP: ah



WHITE RIVER LUMBER COMPANY

ENUMCLAW, WASHINGTON

LETTER FILE

March 5, 1931

Weyerhaeuser Timber Co.
Tacoma,
Washington

Attention Mr. W. L. McCormick

Gentlemen:

We are in receipt of yours of the 3rd enclosing Mr. Titcomb's oath of office but notice that this does not bear the seal of the Notary Public. Shall we return it or paste it in the minute book without the impression of the seal?

Yours very truly,

WHITE RIVER LUMBER COMPANY

By *O. W. Purson*
Asst. Sec.

OWP:ah



WEYERHAEUSER TIMBER COMPANY
TACOMA, WASHINGTON

March 2nd, 1931

Mr. F. E. Weyerhaeuser,
St. Paul, Minnesota

White River Lumber Company

Dear Sir:

Annual Report

We enclose herewith copy of the annual report of White River Lumber Company for the year 1930. You will remember that we acquired our interest in this company as of January 1st, 1930 and therefore this is their first annual report.

During the year 1930 we have installed, as nearly as possible, the Weyerhaeuser system of accounting and cost finding, as you will note from the results and form of the statement.

The operations for the year 1930 were all carried on in the original plant of the White River Lumber Company; the new construction having commenced some time during the latter part of the year and the new plant will be in operation about the first of March this year.

In connection with the logging costs will call your attention to the fact that White River Lumber Company has no real log scale according to the standards of our other companies, the scale which they use being practically the full deck scaled which permitted only 2-1/10% overrun for the year. Therefore their log costs based on this scale are not comparable with the log costs of our other companies based on a log scale which permits an overrun of from 14 to 30 per cent.

WEYERHAEUSER TIMBER COMPANY
TACOMA, WASHINGTON

Mr. F. E. Weyerhaeuser -2-

In addition to the above differences the White River Lumber Company has in past years pursued a policy of charging directly to expense a large number of items which our companies depreciate or spread over future operations in some other manner. Their branch and spur line construction has been charged off each year as built and very little work of this nature was put in during the year 1930. In addition their equipment and plant accounts are fairly well depreciated out and in some cases there was no further depreciation to take.

Will call attention to the average selling prices reflected on Page 31 and will advise that these are net prices after deducting estimated freights and not actual freights. They have always carries "underweights" as a separate profit and this Mr. Long allowed them to do for the year 1930. The underweights are added to the total selling price received at the bottom of Page 31 and also on Page 12.

Will also call your attention to Page 37 on which we have explained the manner in which they price their lumber inventory. At the time the new company was organized this question was referred to Mr. Clapp who advised that he felt we should continue their present basis of inventorying at least until the Government had forced us to change. It is rather doubtful if this company would have shown a profit at all had both its opening and closing lumber inventories been calculated on the basis used by our other companies due to the rather sharp decline in market values December 31, 1930.

WEYERHAEUSER TIMBER COMPANY
TACOMA, WASHINGTON

Mr. F. E. Weyerhaeuser -3-

Will state that we have received full hearted co-
operation from the local management in the matter of conform-
ing their accounting to our methods and as times goes on we
hope to have them on a more correctly comparable basis.

Yours very truly,

WEYERHAEUSER TIMBER COMPANY

F. W. Schomb

Murphy

February 2, 1931

Mr. A. D. Orr:

As soon as you receive trial
balance from White River Lumber Company, Ellenson
under construction, at the end of January, I wish
you would let me look at it in order to check up
insurable values under construction.

Yours very truly,

A. D. Orr

FBM:DB

WHITE RIVER LUMBER COMPANY

ENUMCLAW, WASHINGTON, Feb 2-1931

Mr W. I. McCormick

Tacoma Wash.

OK
W.P.

Dear Mr McCormick

I enclose the three remaining
receipts for the White River Stock.

This will complete the stock
book -

Sincerely yours

A. G. Hanson

W.P.



Cert # 77 to
Harold W. Hanson &
John A. McKinnon, Jr
as trustees under the will
of Jennie W. Hanson, Dec'd

WEYERHAEUSER TIMBER COMPANY
TACOMA, WASHINGTON

January 28, 1931.

Mr. A. G. Hanson,
White River Lumber Company,
Enumclaw, Washington.

Dear Sir:

I have your letter of the 27th having to do with Mr. Bingham. We had no thought of asking Mr. Bingham to come to work with us, nor did we have any thought of taking him into the southern country. What I did have in mind was that possibly we could secure his services long enough to have a day's conversation with Col. Long at some central point when he is making his investigations and naturally we would be very glad to compensate him or you for his time and services.

We appreciate your attitude in regard to this very much and you may rest assured that we will in no way embarrass you or him. We would be very glad indeed to keep your letter confidential.

Yours very truly,

F.R. Titcomb/m

WEYERHAEUSER TIMBER COMPANY.

General Manager

WHITE RIVER LUMBER COMPANY

ENUMCLAW, WASHINGTON



January 27, 1931

Mr. F. R. Titcomb

Weyerhaeuser Timber Company
Tacoma, Washington

Dear Sir:

When Mr. Bingham came to us and made us a proposition to sell our lumber after he told us of his experience, I was struck with the idea that he would be a good man for you. For this reason I wanted him to see you. I am not able to give you any facts about the reason for leaving Krauss but this is what he told us: He was sent to Florida to work up a demand for lumber along the Coast and Islands of the Caribbean Sea and Gulf of Mexico. He said he worked up a big demand for fir and finally Krauss split the territory which cut down Bingham's commission and he became dissatisfied and broke with Krauss.

I understand he received as compensation a commission but Bingham had to stand a portion of the losses he made in charged off accounts. After the conference he had

with you in Tacoma he went back to Seattle and probably told Krauss that he had seen you. Krauss was not willing that he should go to work for you but if he would sell lumber for White River inland, Krauss would cancel the debt Bingham owed him.

All the above I cannot substantiate and may not be the facts so I want you to keep it very confidential.

When Mr. Bingham came here, Mr. Gossard and I both felt he was a good worker and the little time he has been with us and considering the off season and that he is a stranger, has done better than our old men.

He is probably no financier and I know he is hard up. A few days ago we received a letter from him stating that a new baby arrived so in case he is to travel to meet Colonel Long, you probably will have to send him a check. We of course would not hinder him from doing better so anytime you want him we will be glad to release him.

Yours very truly,

A. G. Hanson

A.G.Hanson:sh

WEYERHAEUSER TIMBER COMPANY
TACOMA, WA TON

January 26, 1931

Mr. A. C. Hanson,
White River Lumber Company,
Enumclaw, Washington.

Dear Sir:

In the near future we are going to make a pretty thorough investigation of the possibilities for distributing lumber through the Gulf. Mr. Bingham was with Krause Bros. in that territory and seems to have a very intimate knowledge of that entire picture.

I have suggested to Col. Long who is going down to make this investigation that possibly we could persuade you to let Mr. Bingham get off the road for a week or so or possibly even a few days, to meet with Mr. Long at some central point that is convenient to both of them, for a little talk about this territory, all with the thought that Mr. Long would have one more slant on the picture.

I would rather that you say nothing to Mr. Bingham about this at the present moment, but let me know what your reactions would be to such a plan.

Yours very truly,

WEYERHAEUSER TIMBER COMPANY.

FRT/m

CC to Mr. J.E.L.

WHITE RIVER LUMBER COMPANY

ENUMCLAW, WASHINGTON

January 14, 1931

Mr. F. R. Titcomb

Weyerhaeuser Timber Company

Tacoma, Washington

Dear Sir:

You are certainly right in not publishing the amount of lumber and logs inventories in the trade papers. If some one in the county offices got hold of these figures it might end disastrously for some of us.

Yours truly,

A. G. Hanson



A.G.Hanson:sh